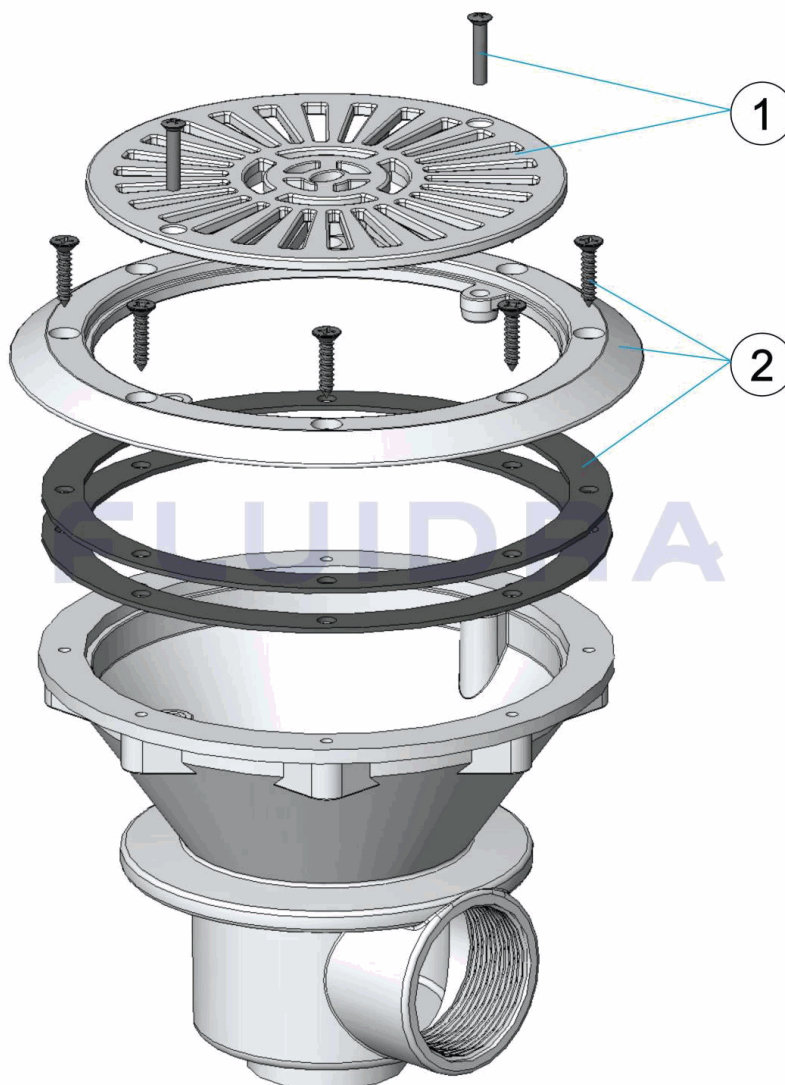

CODIGO **06474, 06474CL090, 06474CL129, 06474CL144**

 DESCRIPCION: **SUMIDERO PISCINA PREFABRICADA D. 210**

ESPAÑOL

POS	CODIGO	DESCRIPCION	POS	CODIGO	DESCRIPCION
1	* 4402021102	REJA SUMIDERO 2' P.PREF.	2	* 4402021103	ARO SUMIDERO 2" PARKE "
1	* 4402020029	REJA SUMIDERO 2' P.PREF.	2	* 4402020015	BRIDA SUMIDERO D. 230 SIN INSERTOS
1	* 4402010122	REJA SUMIDERO 2' P.PREF.	2	* 4402020019	BRIDA SUMIDERO EASY-LINE
1	* 4402020026	REJA SUMIDERO 2' P.PREF.	2	* 4402020020	BRIDA SUMIDERO EASY-LINE

CODIGO **06474, 06474CL090, 06474CL129, 06474CL144**

DESCRIPCION: **SUMIDERO PISCINA PREFABRICADA D. 210**

OBSERVACIONES

POS	CODIGO	OBSERVACIONES
1	4402021102	PARA: 06474 BLANCO / WHITE
1	4402020029	PARA: 06474CL090 BEIGE
1	4402010122	PARA: 06474CL129 GRIS / GREY
1	4402020026	PARA: 06474CL144 ANTRACITA / ANTHRACITE
2	4402021103	PARA: 06474 BLANCO / WHITE
2	4402020015	PARA: 06474CL090 BEIGE
2	4402020019	PARA: 06474CL129 GRIS / GREY
2	4402020020	PARA: 06474CL144 ANTRACITA / ANTHRACITE

CODE **06474, 06474CL090, 06474CL129, 06474CL144**

DESCRIPTION: **BONDE PISCINE PRÉFABRIQUÉE D. 210**

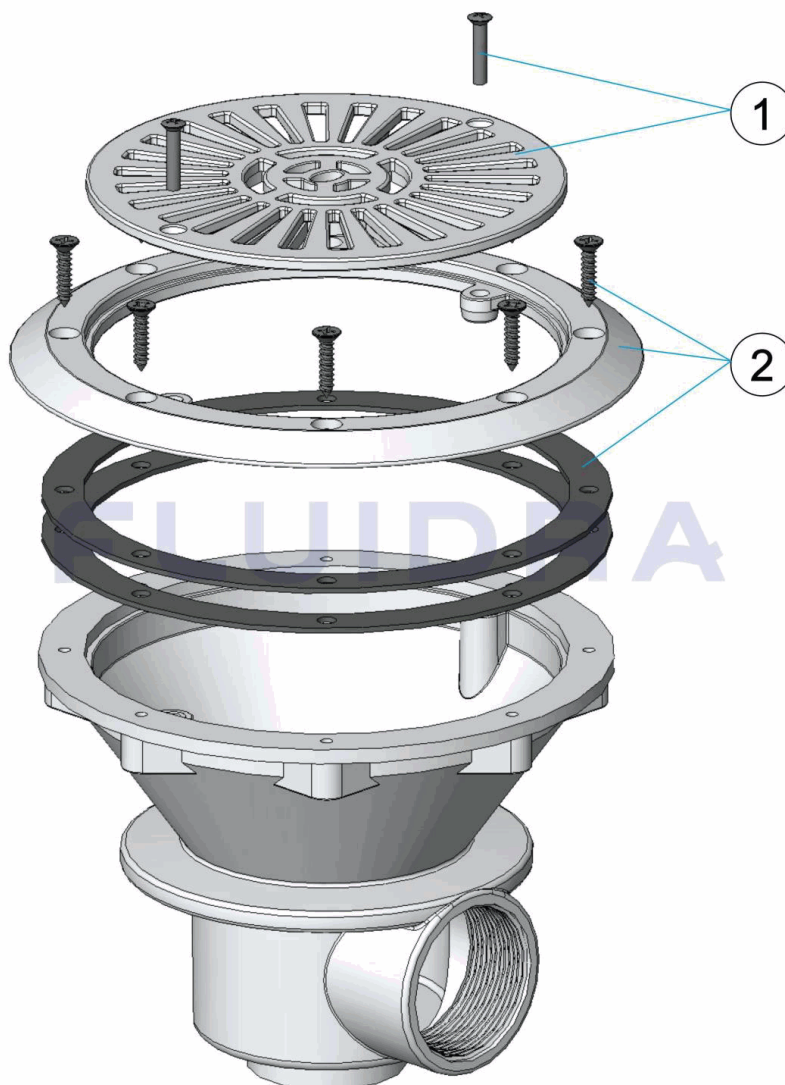

FRANCAIS

POS	CODE	DESCRIPTION	POS	CODE	DESCRIPTION
1	* 4402021102	GRILLE BONDE DE FOND 2' P. LINER	2	* 4402021103	BRIDE BONDE DE FOND 2' PARKER
1	* 4402020029	GRILLE BONDE DE FOND 2' P. LINER	2	* 4402020015	BRIDE BONDE
1	* 4402010122	GRILLE BONDE DE FOND 2' P. LINER	2	* 4402020019	BRIDE BONDE
1	* 4402020026	GRILLE BONDE DE FOND 2' P. LINER	2	* 4402020020	BRIDE BONDE

CODE **06474, 06474CL090, 06474CL129, 06474CL144**

DESCRIPTION: **BONDE PISCINE PRÉFABRIQUÉE D. 210**

OBSERVATIONS

POS	CODE	OBSERVATIONS
1	4402021102	POUR: 06474 BLANCO / WHITE
1	4402020029	POUR: 06474CL090 BEIGE
1	4402010122	POUR: 06474CL129 GRIS / GREY
1	4402020026	POUR: 06474CL144 ANTRACITA / ANTHRACITE
2	4402021103	POUR: 06474 BLANCO / WHITE
2	4402020015	POUR: 06474CL090 BEIGE
2	4402020019	POUR: 06474CL129 GRIS / GREY
2	4402020020	POUR: 06474CL144 ANTRACITA / ANTHRACITE

CODE **06474, 06474CL090, 06474CL129, 06474CL144**

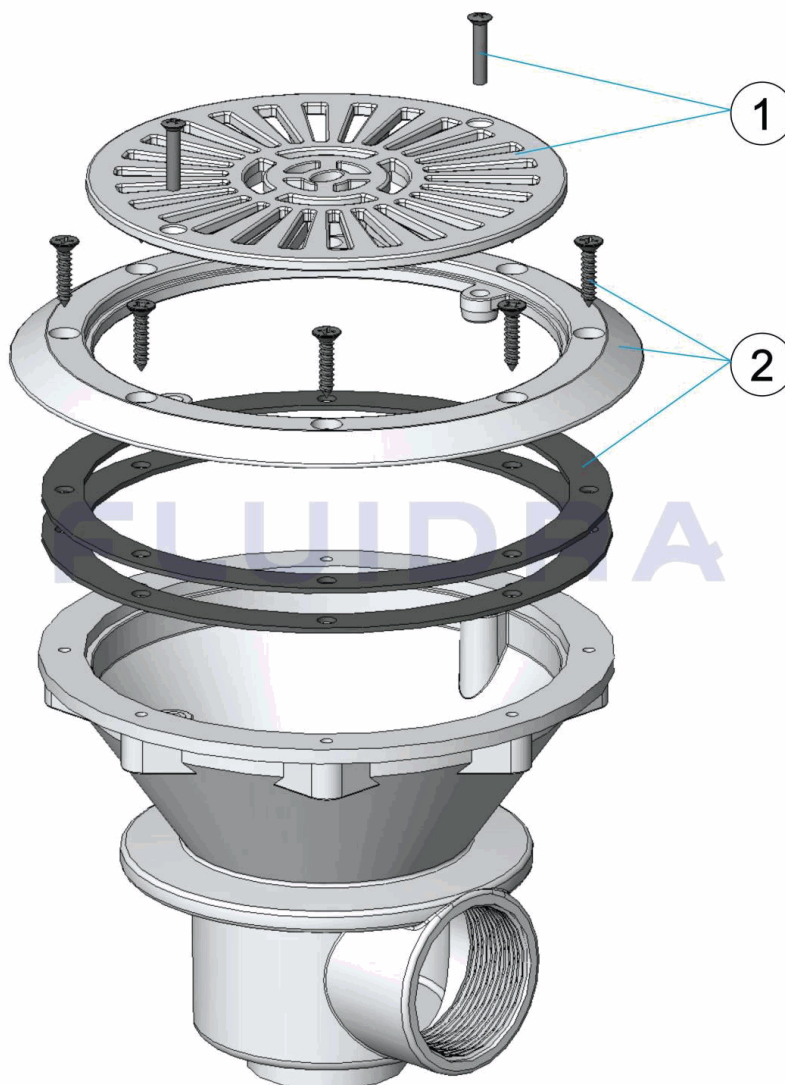
 DESCRIPTION: **DRAIN PREFABRICATED POOL D. 210**

ENGLISH

POS	CODE	DESCRIPTION	POS	CODE	DESCRIPTION
1	* 4402021102	2" DRAIN GRILLE LINER	2	* 4402021103	2" DRAIN FLANGE PARKER
1	* 4402020029	2" DRAIN GRILLE LINER	2	* 4402020015	DRAIN FLANGE
1	* 4402010122	2" DRAIN GRILLE LINER	2	* 4402020019	DRAIN FLANGE
1	* 4402020026	2" DRAIN GRILLE LINER	2	* 4402020020	DRAIN FLANGE

CODE **06474, 06474CL090, 06474CL129, 06474CL144**

DESCRIPTION: **DRAIN PREFABRICATED POOL D. 210**

OBSERVATIONS

POS	CODE	OBSERVATIONS
1	4402021102	FOR: 06474 BLANCO / WHITE
1	4402020029	FOR: 06474CL090 BEIGE
1	4402010122	FOR: 06474CL129 GRIS / GREY
1	4402020026	FOR: 06474CL144 ANTRACITA / ANTHRACITE
2	4402021103	FOR: 06474 BLANCO / WHITE
2	4402020015	FOR: 06474CL090 BEIGE
2	4402020019	FOR: 06474CL129 GRIS / GREY
2	4402020020	FOR: 06474CL144 ANTRACITA / ANTHRACITE

CODICE **06474, 06474CL090, 06474CL129, 06474CL144**

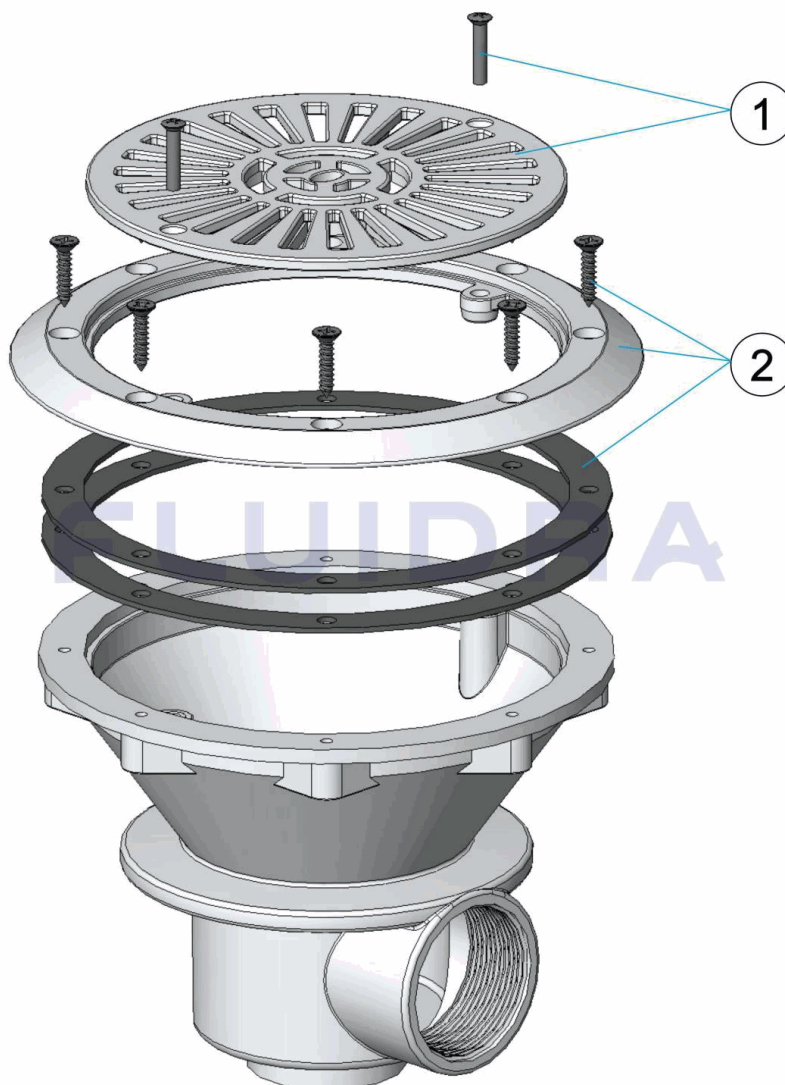
 DESCRIZIONE: **SCOLATOIO PISCINA PREFABBRICATA D. 210**

ITALIANO

POS	CODICE	DESCRIZIONE	POS	CODICE	DESCRIZIONE
1	* 4402021102	GRIGLIA 2' P.PREF	2	* 4402021103	FLANGIA 2' PARKER
1	* 4402020029	GRIGLIA 2' P.PREF	2	* 4402020015	FLANGIA FORO DI SCOLO
1	* 4402010122	GRIGLIA 2' P.PREF	2	* 4402020019	FLANGIA FORO DI SCOLO
1	* 4402020026	GRIGLIA 2' P.PREF	2	* 4402020020	FLANGIA FORO DI SCOLO

CODICE **06474, 06474CL090, 06474CL129, 06474CL144**

DESCRIZIONE: **SCOLATOIO PISCINA PREFABBRICATA D. 210**

OSSERVAZIONI

POS	CODICE	OSSERVAZIONI
1	4402021102	PER: 06474 BLANCO / WHITE
1	4402020029	PER: 06474CL090 BEIGE
1	4402010122	PER: 06474CL129 GRIS / GREY
1	4402020026	PER: 06474CL144 ANTRACITA / ANTHRACITE
2	4402021103	PER: 06474 BLANCO / WHITE
2	4402020015	PER: 06474CL090 BEIGE
2	4402020019	PER: 06474CL129 GRIS / GREY
2	4402020020	PER: 06474CL144 ANTRACITA / ANTHRACITE

CODE **06474, 06474CL090, 06474CL129, 06474CL144**

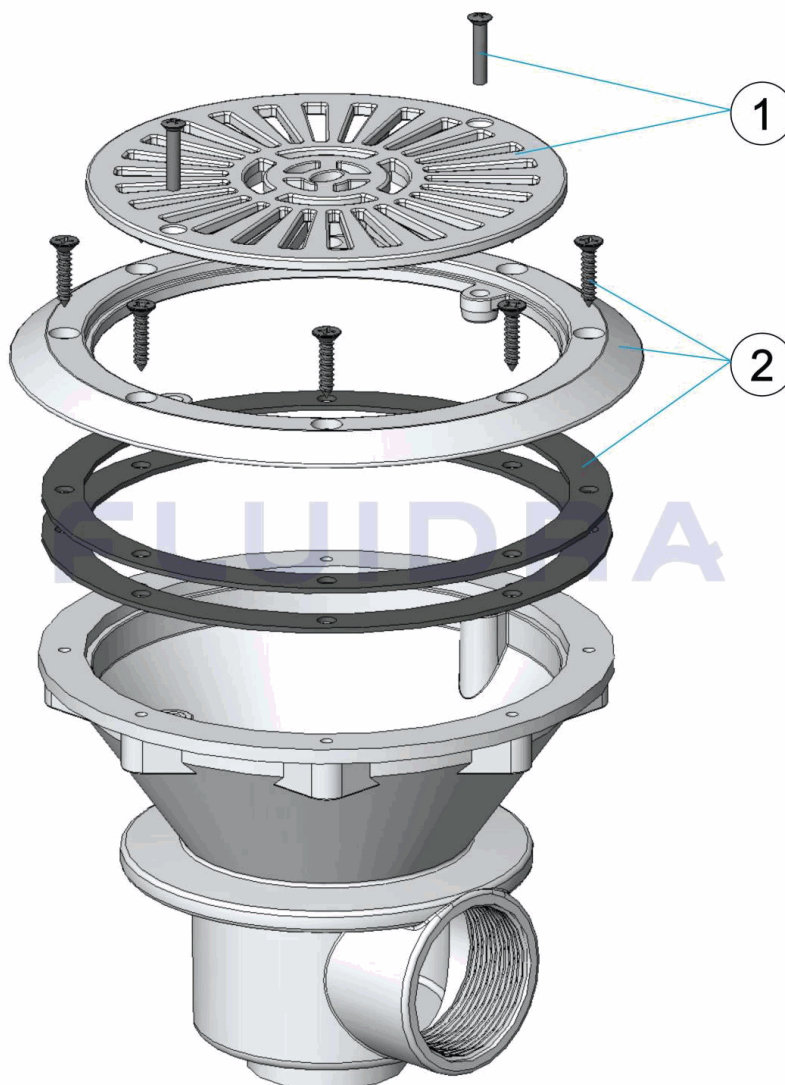
 BESCHREIBUNG: **ABFLUSS FERTIGBECKEN D. 210**

DEUTSCH

POS	CODE	BESCHREIBUNG	POS	CODE	BESCHREIBUNG
1	* 4402021102	ABFLUSSGITTER 2' FERTIGBECKEN	2	* 4402021103	RING ABFLUSS 2" PARKE "
1	* 4402020029	ABFLUSSGITTER 2' FERTIGBECKEN	2	* 4402020015	FLANSCH ABFLUSS D. 230 OHNE EINSÄTZE
1	* 4402010122	ABFLUSSGITTER 2' FERTIGBECKEN	2	* 4402020019	FLANSCH ABFLUSS
1	* 4402020026	ABFLUSSGITTER 2' FERTIGBECKEN	2	* 4402020020	FLANSCH ABFLUSS

CODE **06474, 06474CL090, 06474CL129, 06474CL144**

BESCHREIBUNG: **ABFLUSS FERTIGBECKEN D. 210**

HINWEISE

POS	CODE	HINWEISE
1	4402021102	FÜR: 06474 BLANCO / WHITE
1	4402020029	FÜR: 06474CL090 BEIGE
1	4402010122	FÜR: 06474CL129 GRIS / GREY
1	4402020026	FÜR: 06474CL144 ANTRACITA / ANTHRACITE
2	4402021103	FÜR: 06474 BLANCO / WHITE
2	4402020015	FÜR: 06474CL090 BEIGE
2	4402020019	FÜR: 06474CL129 GRIS / GREY
2	4402020020	FÜR: 06474CL144 ANTRACITA / ANTHRACITE

CODIGO **06474, 06474CL090, 06474CL129, 06474CL144**

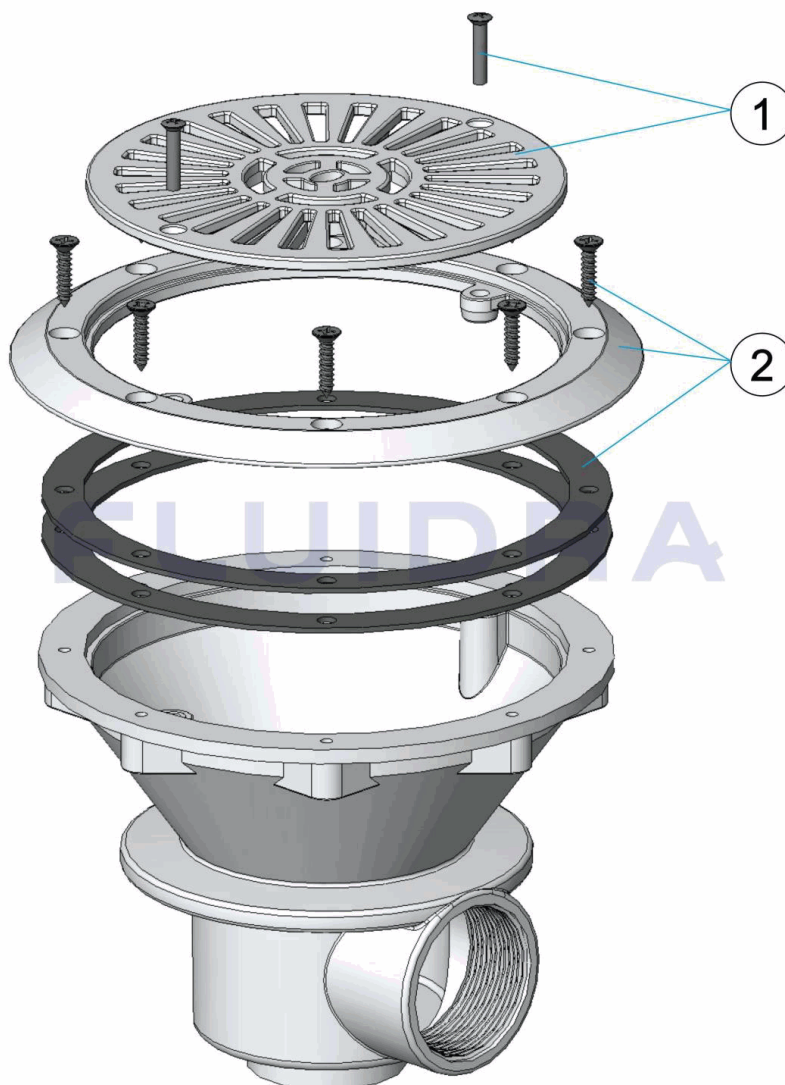
 DESCRIÇÃO: **ESGOTO PISCINA PRÉ-FABRICADA**

PORTUGUES

POS	CODIGO	DESCRIÇÃO	POS	CODIGO	DESCRIÇÃO
1	* 4402021102	GRELHA RALO DE FUNDO 2' P.PREF	2	* 4402021103	ARO RALO DE FUNDO 2' PARKER
1	* 4402020029	GRELHA RALO DE FUNDO 2' P.PREF	2	* 4402020015	FLANGE RALO DE FUNDO
1	* 4402010122	GRELHA RALO DE FUNDO 2' P.PREF	2	* 4402020019	FLANGE RALO DE FUNDO
1	* 4402020026	GRELHA RALO DE FUNDO 2' P.PREF	2	* 4402020020	FLANGE RALO DE FUNDO

CODIGO **06474, 06474CL090, 06474CL129, 06474CL144**

DESCRIÇÃO: **ESGOTO PISCINA PRÉ-FABRICADA**

OBSERVAÇÕES

POS	CODIGO	OBSERVAÇÕES
1	4402021102	PARA: 06474 BLANCO / WHITE
1	4402020029	PARA: 06474CL090 BEIGE
1	4402010122	PARA: 06474CL129 GRIS / GREY
1	4402020026	PARA: 06474CL144 ANTRACITA / ANTHRACITE
2	4402021103	PARA: 06474 BLANCO / WHITE
2	4402020015	PARA: 06474CL090 BEIGE
2	4402020019	PARA: 06474CL129 GRIS / GREY
2	4402020020	PARA: 06474CL144 ANTRACITA / ANTHRACITE