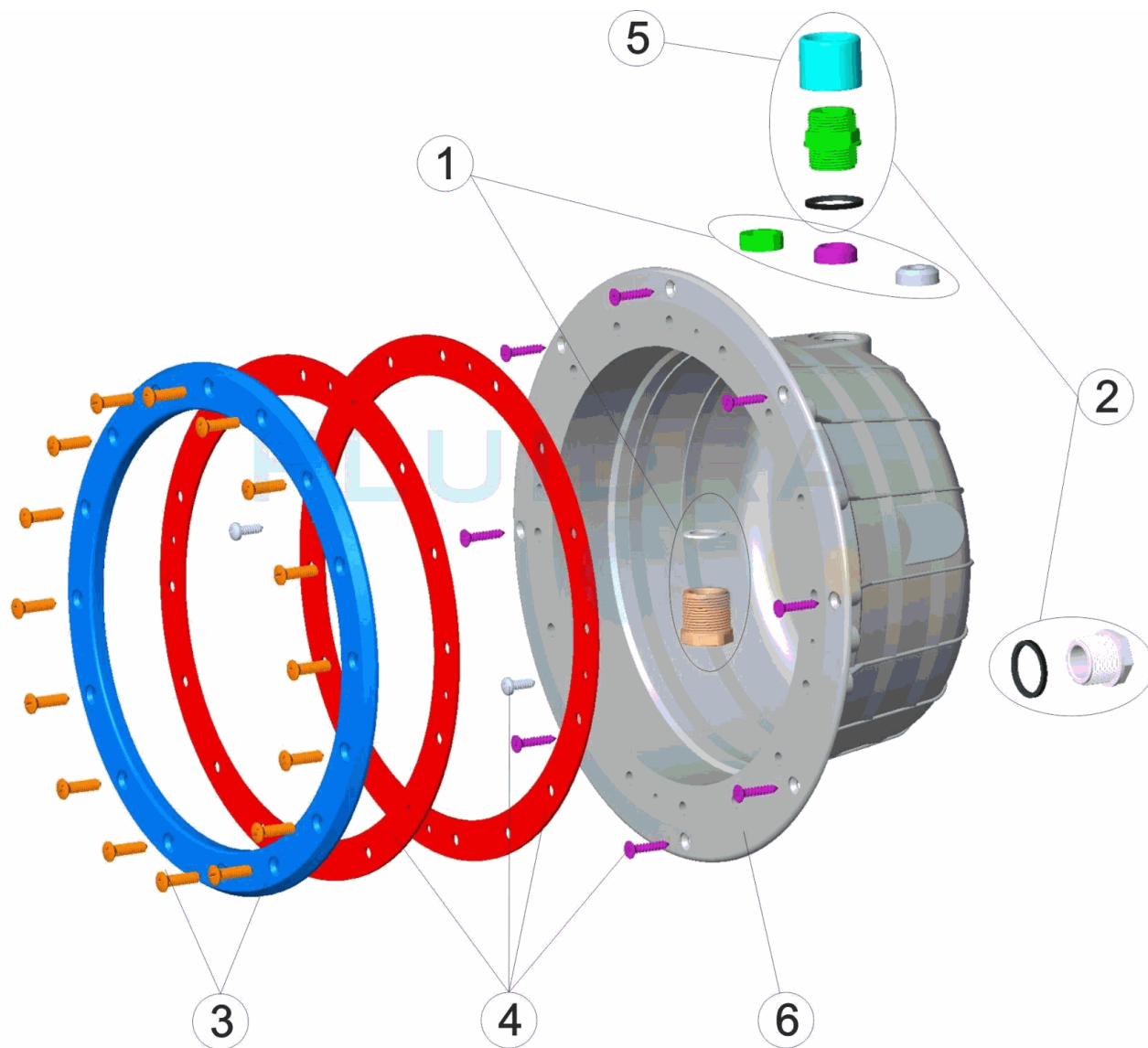

CODIGO **23670, 23671**

 DESCRIPCION: **NICHO PROYECTOR STANDARD PARA PANELES CON Y SIN INSERTOS**

**ESPAÑOL**

POS	CODIGO	DESCRIPCION	POS	CODIGO	DESCRIPCION
1	4403010801	CJTO. PRENSAESTOPAS	4	4403010402	JUNTA ADHESIVA ANCHA PROYECTOR STD
2	4403010313	PRENSAESTOPAS CUERPO PROYECTOR M-25	5	4403010802	MANGUITO M-25
3	* 4403013506	BRIDA FIJACION PROYECTOR (PARKER)	6	* 23670R0002	NICHO PROYECTOR
3	* 4403010401	BRIDA FIJACION ANCHA PROY.STD.	6	* 23671R0001	NICHO PROYECTOR STANDARD

CODIGO **23670, 23671**

DESCRIPCION: **NICHO PROYECTOR STANDARD PARA PANELES CON Y SIN INSERTOS**

**OBSERVACIONES**

POS	CODIGO	OBSERVACIONES
3	4403013506	PARA: 23670
3	4403010401	PARA: 23671
6	23670R0002	PARA: 23670
6	23671R0001	PARA: 23671

CODE **23670, 23671**

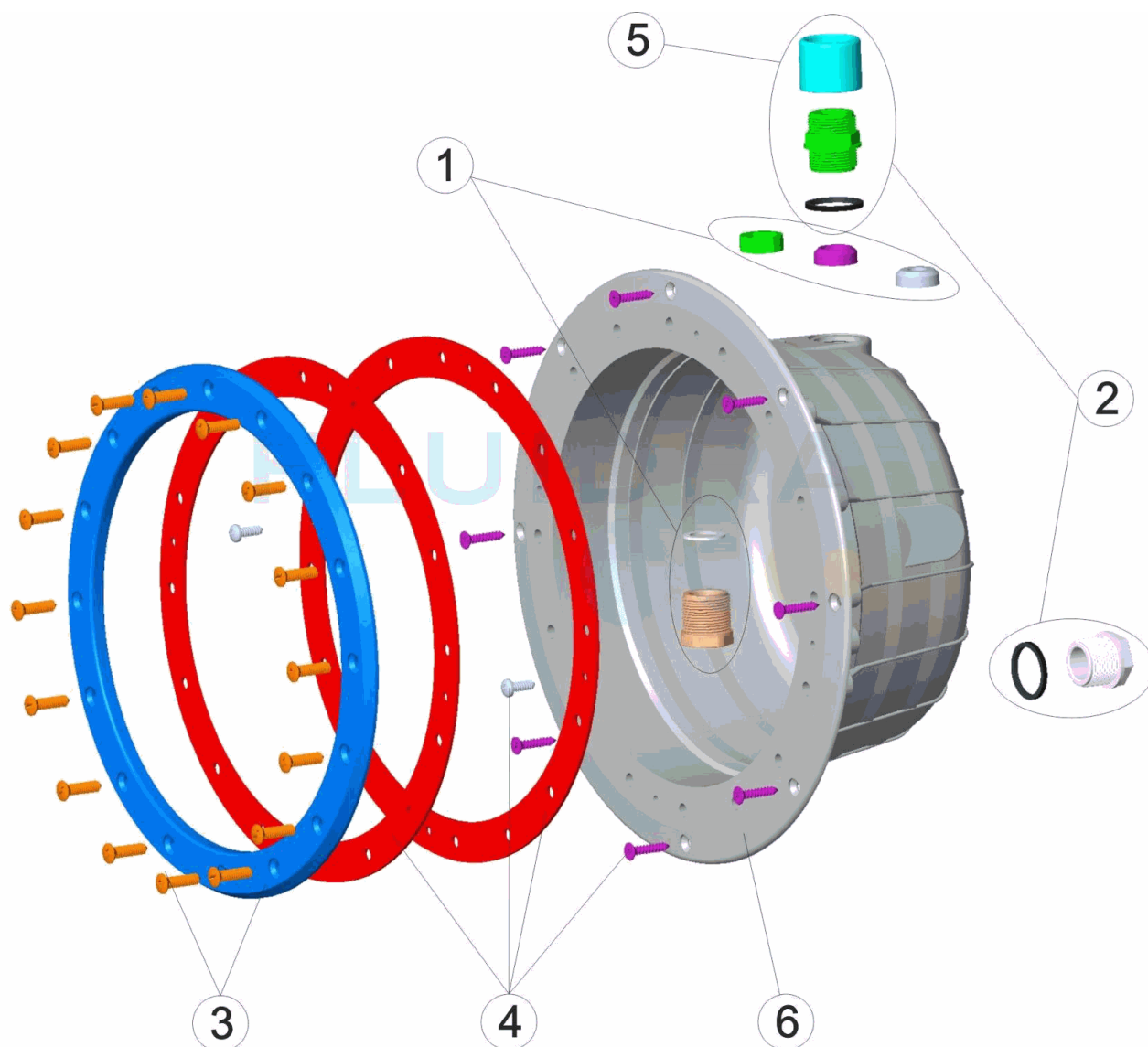
 DESCRIPTION: **NICHE PROJECTEUR STANDARD POUR PANNEAUX AVEC ET SANS INSERTS**

**FRANCAIS**

POS	CODE	DESCRIPTION	POS	CODE	DESCRIPTION
1	4403010801	ENS. PRESSE ETOUPE	4	4403010402	JOINT ADHESIF
2	4403010313	CORPS PRESSE ETOUPE M-25	5	4403010802	MANCHON M-25
3	* 4403013506	BRIDE FIXATION PROJECTEUR (PARKER)	6	* 23670R0002	NICHE PROJECTEUR
3	* 4403010401	BRIDE FIXATION PROJECTEUR	6	* 23671R0001	NICHE PISCINE POLYMÈRE

CODE **23670, 23671**

DESCRIPTION: **NICHE PROJECTEUR STANDARD POUR PANNEAUX AVEC ET SANS INSERTS**

**OBSERVATIONS**

POS	CODE	OBSERVATIONS
3	4403013506	POUR: 23670
3	4403010401	POUR: 23671
6	23670R0002	POUR: 23670
6	23671R0001	POUR: 23671

CODE                    **23670, 23671**

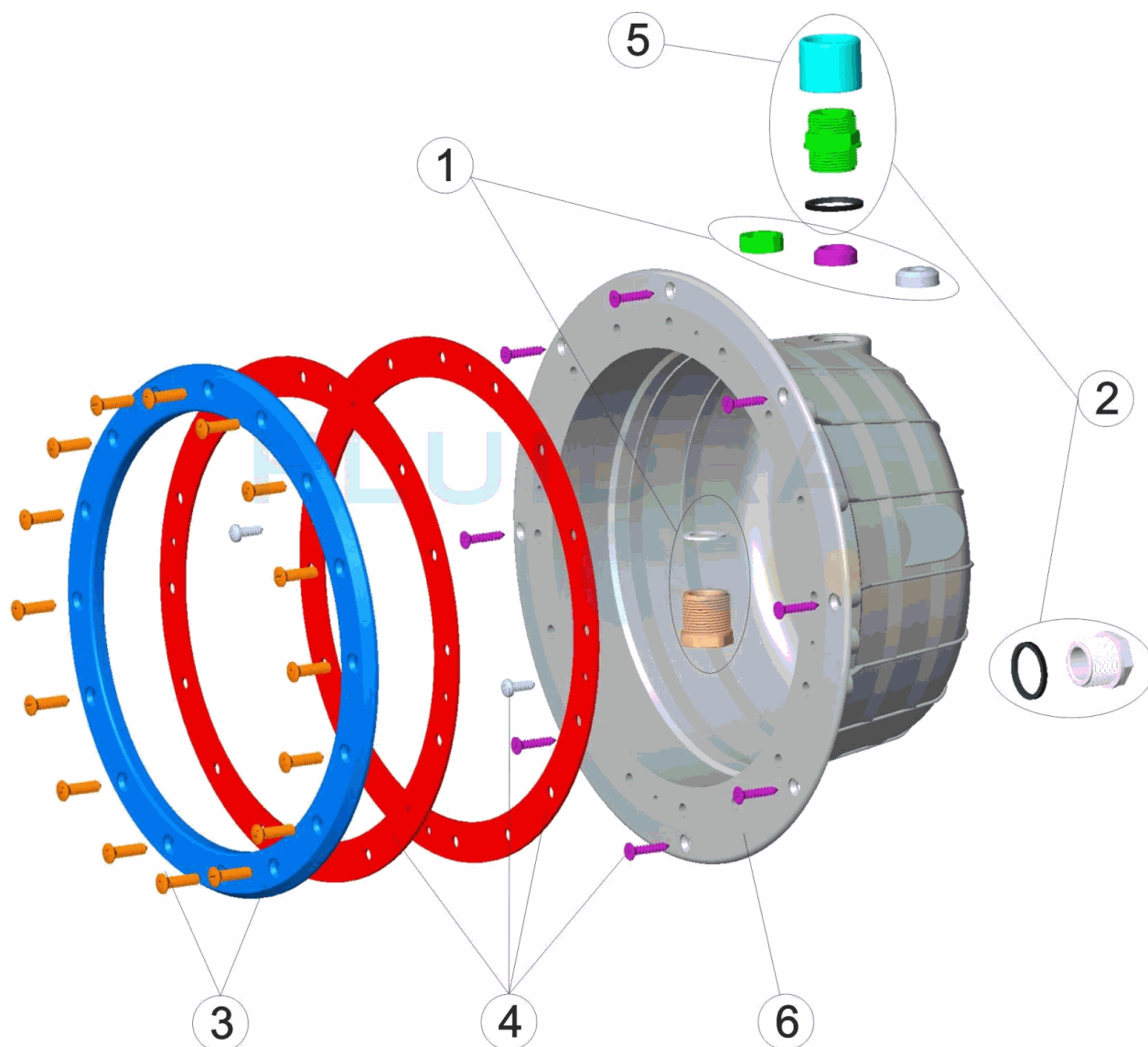
 DESCRIPTION: **STANDARD LIGHT NICHE FOR PANELS WITH AND WITHOUT INSERTS**

**ENGLISH**

POS	CODE	DESCRIPTION	POS	CODE	DESCRIPTION
1	4403010801	GLAND SEAL ASSY.	4	4403010402	ADHESIVE GASKET
2	4403010313	BODY PACKING GLAND M-25	5	4403010802	MUFF M-25
3	* 4403013506	LIGHT FIXING FLANGE (PARKER)	6	* 23670R0002	FLOODLAMP HOUSING
3	* 4403010401	LIGHT FIXING FLANGE	6	* 23671R0001	PANELLED POOL HOUSING

CODE **23670, 23671**

DESCRIPTION: **STANDARD LIGHT NICHE FOR PANELS WITH AND WITHOUT INSERTS**

## OBSERVATIONS

POS	CODE	OBSERVATIONS
3	4403013506	FOR: 23670
3	4403010401	FOR: 23671
6	23670R0002	FOR: 23670
6	23671R0001	FOR: 23671

CODICE **23670, 23671**

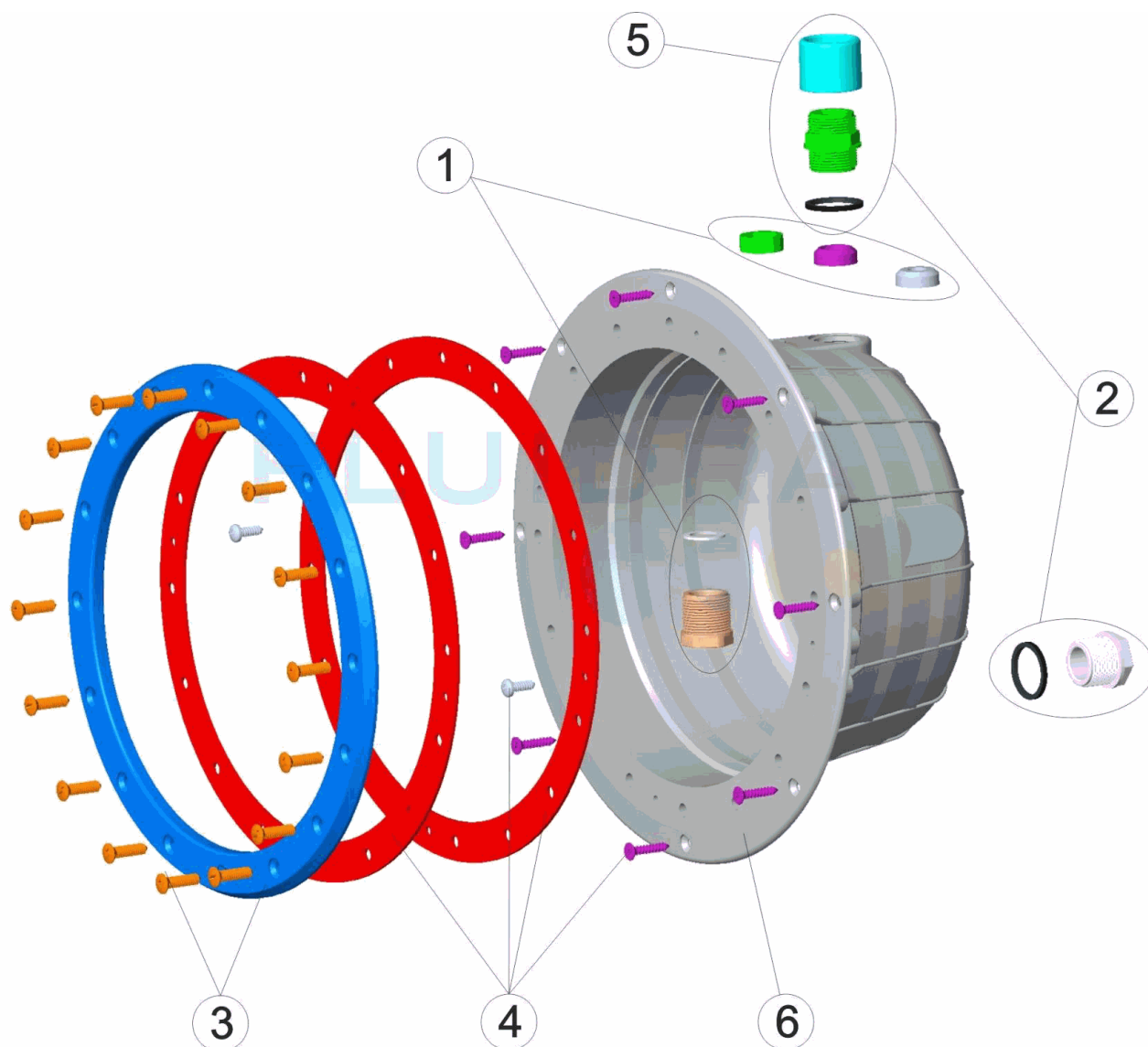
 DESCRIZIONE: **NICCHIA PROIETTORE STANDARD PER PANNELLI CON E SENZA INSERTI**

**ITALIANO**

POS	CODICE	DESCRIZIONE	POS	CODICE	DESCRIZIONE
1	4403010801	KIT PRESSACAVI	4	4403010402	GUARNIZIONE ADESIVA
2	4403010313	PRESSACAVI CORPO M-25	5	4403010802	MANICOTTO M-25
3	* 4403013506	FLANGIA FISSAGGIO FARO (PARKER)	6	* 23670R0002	NICCHIA PROIETTORE
3	* 4403010401	FLANGIA FISSAGGIO FARO	6	* 23671R0001	NICCHIA PISCINA PANELI

CODICE **23670, 23671**

 DESCRIZIONE: **NICCHIA PROIETTORE STANDARD PER PANNELLI CON E SENZA INSERTI**

## OSSERVAZIONI

POS	CODICE	OSSERVAZIONI
3	4403013506	PER: 23670
3	4403010401	PER: 23671
6	23670R0002	PER: 23670
6	23671R0001	PER: 23671

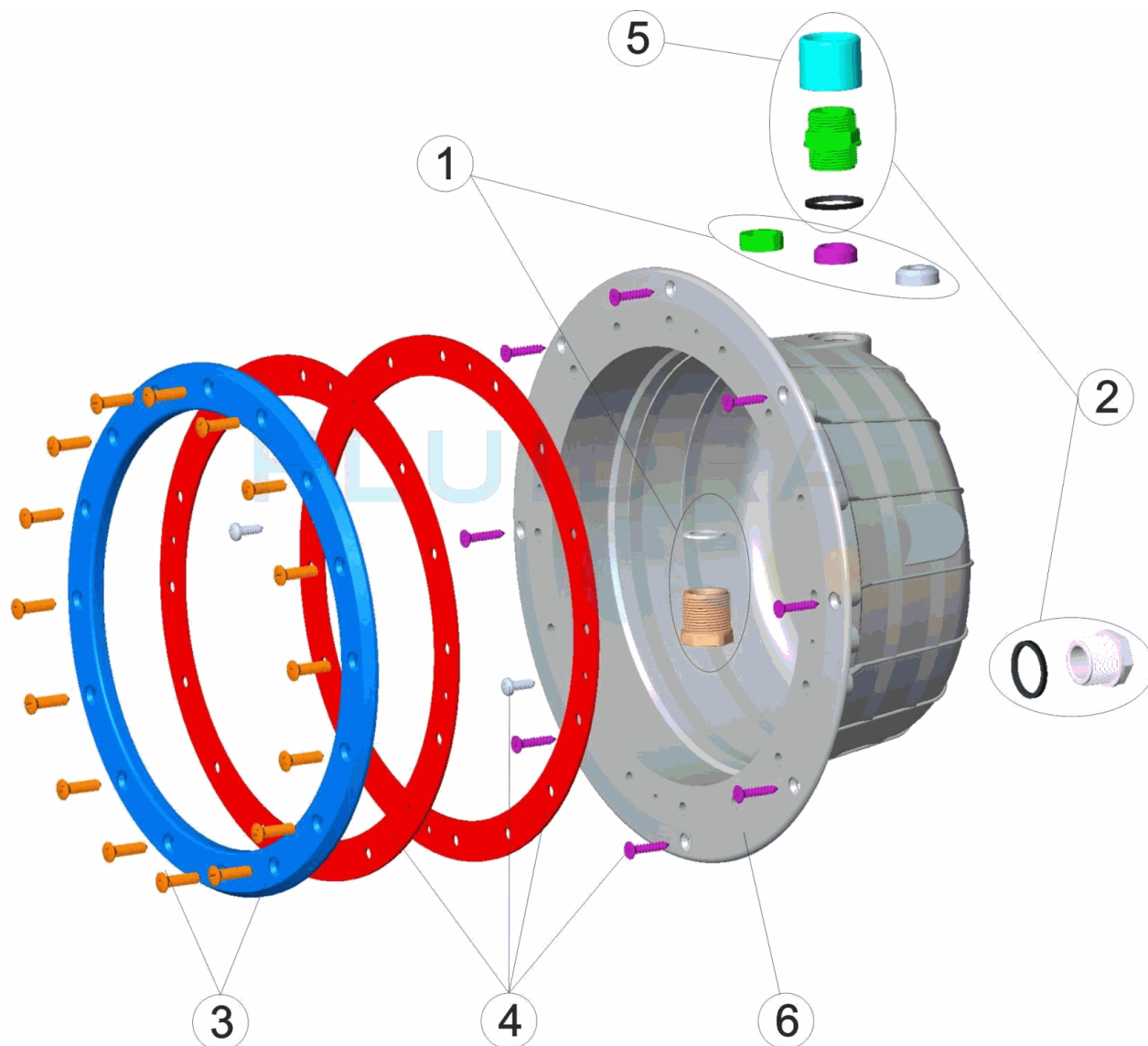

CODE                    **23670, 23671**

 BESCHREIBUNG: **EINBAUTOPF UWS STANDARD FÜR PLATTEN MIT UND OHNE EINSÄTZEN**

**DEUTSCH**

POS	CODE	BESCHREIBUNG	POS	CODE	BESCHREIBUNG
1	4403010801	SET QUETSCHVERSCHRAUBUNG	4	4403010402	DICHTUNG SELBSTKLEBEND BREIT UWS STD
2	4403010313	QUETSCHVERSCHRAUBUNG GEHÄUSE UWS M-25	5	4403010802	NIPPEL M-25
3	* 4403013506	BEFESTIGUNGSFLANSCH UWS (PARKER)	6	* 23670R0002	EINBAUTOPF UWS
3	* 4403010401	BEFESTIGUNGSFLANSCH BREIT UWS STD.	6	* 23671R0001	EINBAUTOPF UWS STANDARD

CODE **23670, 23671**

BESCHREIBUNG: **EINBAUTOPF UWS STANDARD FÜR PLATTEN MIT UND OHNE EINSÄTZEN**

## HINWEISE

POS	CODE	HINWEISE
3	4403013506	FÜR: 23670
3	4403010401	FÜR: 23671
6	23670R0002	FÜR: 23670
6	23671R0001	FÜR: 23671

CODIGO **23670, 23671**

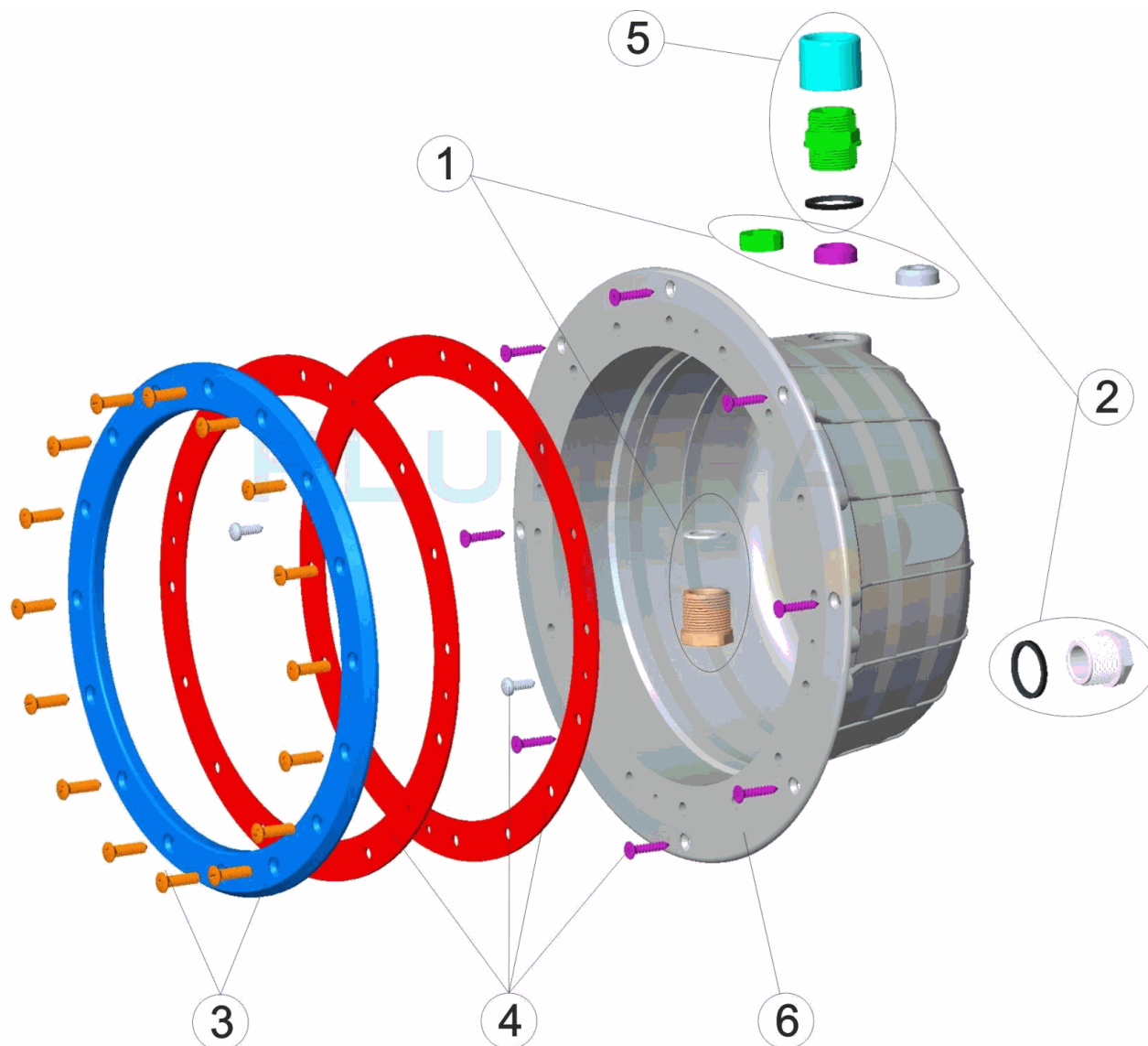
 DESCRIÇÃO: **NICHO PROJECTOR STANDARD PARA PAINÉIS COM E SEM INSERÇÕES**

**PORTUGUES**

POS	CODIGO	DESCRIÇÃO	POS	CODIGO	DESCRIÇÃO
1	4403010801	CONJ.CAIXA DE VEDAÇÃO	4	4403010402	JUNTA ADESIVA
2	4403010313	BUCIN CORPO M-25	5	4403010802	MANGUITO M-25
3	* 4403013506	FLANGE FIXAÇÃO PROJECTOR (PARKER)	6	* 23670R0002	NICHO PROJECTOR
3	* 4403010401	FLANGE FIXAÇÃO PROJECTOR	6	* 23671R0001	NITXO PISCINA DE PANELES

CODIGO **23670, 23671**

DESCRIÇÃO: **NICHO PROJECTOR STANDARD PARA PAINÉIS COM E SEM INSERÇÕES**

## OBSERVAÇÕES

POS	CODIGO	OBSERVAÇÕES
3	4403013506	PARA: 23670
3	4403010401	PARA: 23671
6	23670R0002	PARA: 23670
6	23671R0001	PARA: 23671