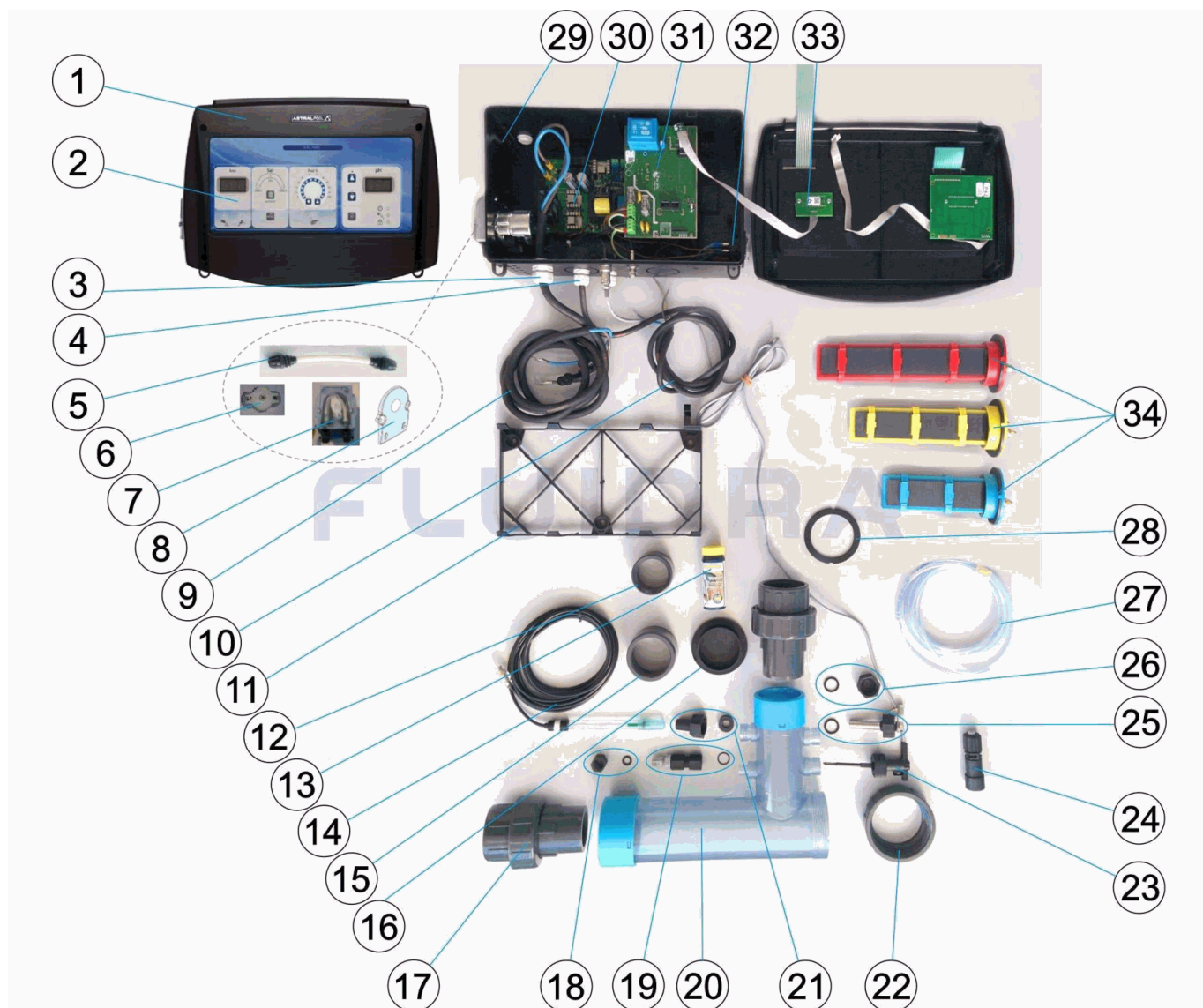

CODIGO **60238, 60239, 60240, 66678, 66679, 66680**

 DESCRIPCION: **ELECTROLISIS DUAL PURE 60, 100, 160**

**ESPAÑOL**

POS	CODIGO	DESCRIPCION	CANTIDAD	POS	CODIGO	DESCRIPCION	CANTIDAD
1	4408060043	TAPA CUERPO DUAL PURE		15	4408060102	REDUCCION 75/63	
2	4408060046	CARATULA DUAL PURE		16	4408060112	CJTO. RACORD	
3	4408060051	CJTO PRENSAESTOPAS PG 11		17	4408060104	RACCOR UNION A COLLAR M/H. 63	
4	4408060050	CJTO PRENSAESTOPAS PG 16		18	4408060008	TAPON PEQUEÑO INYECCIÓN PARA VASC	
5	4408060022	TUBO LATEX CON RACORES		19	4408060019	TOMA INYECCIÓN COMPLETA PARA VASC	
6	4408040049	PORTA RODILLOS PH MODELO 2 1,8-2,4		20	* 4408060128	CARCASA PORTACELULAS (60 M3)	
7	4408060039	BOMBA PH 2,4 L/H.		20	* 4408060129	CARCASA PORTACELULA (100 M3)	
8	4408060080	CUBIERTA TRANSPARENTE BOMBA L3 MOD		20	* 4408060101	CARCASA PORTACELULAS (40 - 160 M3)	
9	4408060002	CABLE ELECTRODO COMPLETO		21	4408060116	PORTASONDA COMPLETO PARA VASO	
10	4408060003	CABLE ALIMENTACION 3X1MM2 2.1M		22	4408060105	TUERCA D. 92 ELECTRODO SEL + JUNTA	
11	4408040037	SOPORTE MURAL		23	4408060108	FLUXOSTATO COMPLETO	
12	4408060103	REDUCCION 63/50		24	4408060118	TOMA ASPIRACION COMPLETA	
13	4408060007	ESTUCHE ANALISIS SEL		25	4408060026	TOMA TIERRA VASO	

\* VER HOJA DE OBSERVACIONES

CODIGO **60238, 60239, 60240, 66678, 66679, 66680**

DESCRIPCION: **ELECTROLISIS DUAL PURE 60, 100, 160**

14	4408060117	SONDA PH	26	4408060121	TAPON NEGRO OBTURADOR + JUNTA
27	4408040028	TUBO PVC TRANSPARENTE 4X6MM L=4M	32	4408060055	INTERRUPTOR CON CAPUCHON
28	4408060106	JUNTA PLANA ELECTRODO SEL	33	4408060057	TARJETA PH ECCO E5 PANTALLA DEPOR'
29	4408060028	CARCASA SEL PURE V4	34	* 54054	ELECTRODO SEL 60 - 9 PLACAS
30	4408060044	TARJETA V4 CONEXION LARGA CON DISPLA	34	* 28421	ELECTRODO SEL 100 - 9 PLACAS
31	4408060144	TARJETA PH ECCO E5 SIN DISPLAY	34	* 28422	ELECTRODO SEL 160 9 PLACAS

CODIGO **60238, 60239, 60240, 66678, 66679, 66680**

DESCRIPCION: **ELECTROLISIS DUAL PURE 60, 100, 160**

**OBSERVACIONES**

POS	CODIGO	OBSERVACIONES
20	4408060128	PARA: 60238, 66678
20	4408060129	PARA: 60239, 66679
20	4408060101	PARA: 60240, 66680
34	54054	PARA: 60238, 66678
34	28421	PARA: 60239, 66679
34	28422	PARA: 60240, 66680

CODE **60238, 60239, 60240, 66678, 66679, 66680**

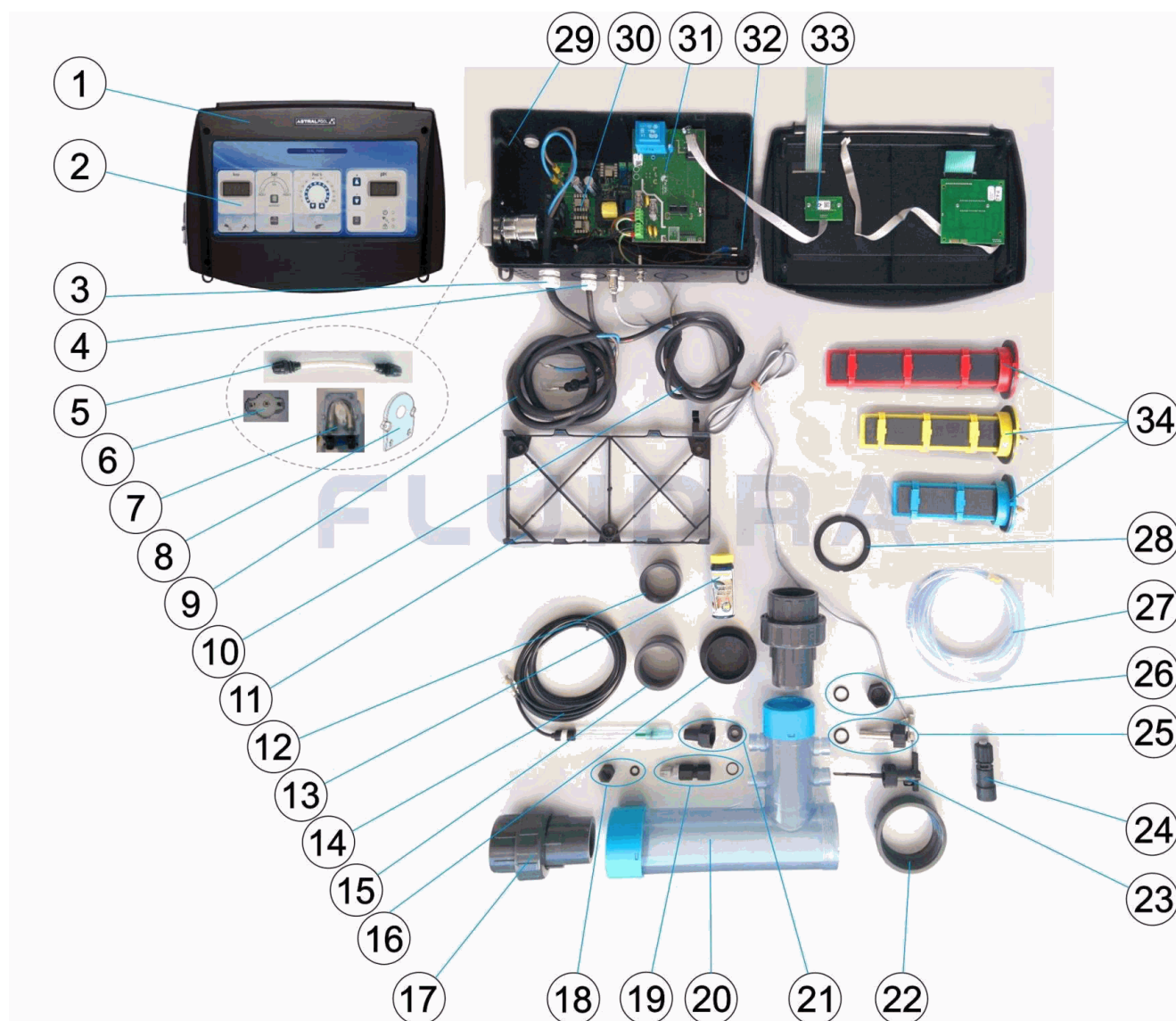
 DESCRIPTION: **ÉLECTROLYSE DUAL PURE 60, 100, 160**

**FRANCAIS**

POS	CODE	DESCRIPTION	QUANTITE	POS	CODE	DESCRIPTION	QUANTITE
1	4408060043	COUVERCLE DUAL PURE		15	4408060102	RÉDUCTION 75/63	
2	4408060046	COUVERCLE DUAL PURE		16	4408060112	ENSEMBLE RACCORD	
3	4408060051	ENS. PRESSE-ÉTOUPES PG11		17	4408060104	RACCORD UNION À COLLER M/H 63	
4	4408060050	ENS. PRESSE-ÉTOUPES PG16		18	4408060008	BOUCHON PETIT INJECTION POUR VASE	
5	4408060022	TUYAU EN CAOUTCHOUC		19	4408060019	PRISE INJECTION COMPLÈTE POUR VASE	
6	4408040049	GALET POMPE PH MODELE 2 1,8-2,4		20	* 4408060128	PORTE-CELLULE (60 M3)	
7	4408060039	POMPE PERI-STAT 2.4 L/H MODELE		20	* 4408060129	PORTE-CELLULE (100 M3)	
8	4408060080	CAPOT TRANSPARENT POMPE L3 MODELE		20	* 4408060101	PORTE-CELLULE (40 - 160 M3)	
9	4408060002	CABLE ELECTRODE		21	4408060116	PORTE-SONDE COMPLET	
10	4408060003	CABLE ALIMENTATION 3X1MM2 2.1M		22	4408060105	ECROU D. 92 ELECTRODE SEL + JOINT	
11	4408040037	SUPPORT MURAL		23	4408060108	CONTROLEUR DE DÉBIT COMPLET	
12	4408060103	RÉDUCTION 63/50		24	4408060118	COUVERCLE DE SONDE	
13	4408060007	KIT ANALYSE SEL		25	4408060026	PRISE DE TERRE	

\* VOIR FICHE D'OBSERVATIONS

CODE **60238, 60239, 60240, 66678, 66679, 66680**

DESCRIPTION: **ÉLECTROLYSE DUAL PURE 60, 100, 160**

14	4408060117	SONDE PH	26	4408060121	COUVERCLE NOIR DE FERMENTURE + JO
27	4408040028	TUBE PVC COLIBRI TRNSPARENT COUPE 4)	32	4408060055	INTER DEPORTE+CAPUCHON ANALYS3
28	4408060106	JOINT PLAT ÉLECTRODE SEL	33	4408060057	CARTE PH ECCO E5 AFFI. DEPORTE
29	4408060028	CARCASSE SEL PURE V4	34	* 54054	ELECTRODE SEL 60 -9 PLAQUES
30	4408060044	CARTE V4 CONNEXION LONGUE AVEC AFFI	34	* 28421	ELECTRODE SEL 100 -9 PLAQUES
31	4408060144	CARTE PH ECCO E5 SANS AFFICHEUR	34	* 28422	ELECTRODE SEL 160 -9 PLAQUES

CODE **60238, 60239, 60240, 66678, 66679, 66680**

DESCRIPTION: **ÉLECTROLYSE DUAL PURE 60, 100, 160**

## OBSERVATIONS

POS	CODE	OBSERVATIONS
20	4408060128	POUR: 60238, 66678
20	4408060129	POUR: 60239, 66679
20	4408060101	POUR: 60240, 66680
34	54054	POUR: 60238, 66678
34	28421	POUR: 60239, 66679
34	28422	POUR: 60240, 66680

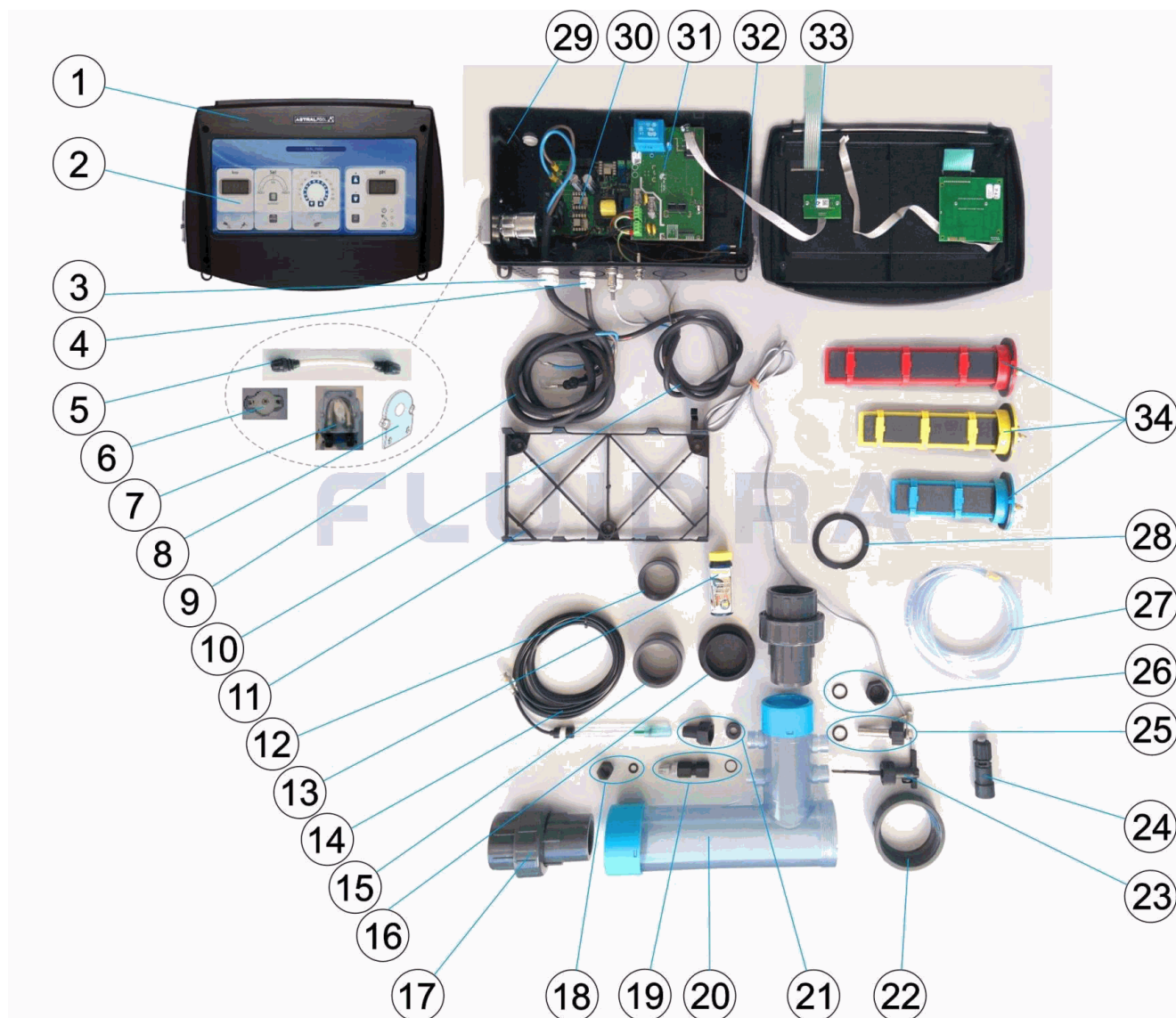

CODE **60238, 60239, 60240, 66678, 66679, 66680**

 DESCRIPTION: **ELECTROLYSIS DUAL PURE 60, 100, 160**

## ENGLISH

POS	CODE	DESCRIPTION	QUANTITY	POS	CODE	DESCRIPTION	QUANTITY
1	4408060043	COVER DUAL PURE		15	4408060102	75/63 REDUCTION SOCKET	
2	4408060046	COVER DUAL PURE		16	4408060112	CONNECTOR SET	
3	4408060051	PG11 PACKING GLAND UNIT		17	4408060104	M/F 63 SOLVENT SOCKET UNION	
4	4408060050	PG16 PACKING GLAND UNIT		18	4408060008	SMALL INJECTION CAP FOR RECIPIENT	
5	4408060022	LATEX TUBE		19	4408060019	COMPLETE INJECTION SAMPLE FOR CUF	
6	4408040049	MODEL 2 1.8-2.4 PH ROLLER HOLDER		20	* 4408060128	ELECTRODES HOUSING (60 M3)	
7	4408060039	2.4 L/H PERISTALTIC PUMP		20	* 4408060129	ELECTRODES HOUSING (100 M3)	
8	4408060080	L3 PUMP MOD. 2 TRANSPARENT COVER		20	* 4408060101	ELECTRODES HOUSING (40 - 160 M3)	
9	4408060002	ELECTRODE CABLE		21	4408060116	COMPLETE CELL (HOUSING + ELECTROD	
10	4408060003	3X1MM2 2.1M SUPPLY CABLE		22	4408060105	D. 92 ELECTRODE NUT + GASKET	
11	4408040037	WALL BRACKET		23	4408060108	COMPLETE FLOWSWITCH	
12	4408060103	63/50 REDUCTION SOCKET		24	4408060118	COMPLETE SUCTION VALVE	
13	4408060007	SEL ANALYSIS CASE		25	4408060026	EARTH CONNECTION	

\* SEE OBSERVATIONS SHEET

CODE **60238, 60239, 60240, 66678, 66679, 66680**

DESCRIPTION: **ELECTROLYSIS DUAL PURE 60, 100, 160**

14	4408060117	PH PROBE	26	4408060121	BLACK OBTURATING PLIG + GASKET
27	4408040028	4X6MM L=4M TRANSPARENT PVC TUBING	32	4408060055	CIRCUIT BREAKER
28	4408060106	ELECTRODE GASKET	33	4408060057	PH CARD ECCO E5
29	4408060028	SEL PURE V4 SHELL	34	* 54054	ASTRAL SEL 60 ELECTRODE (9 PLATES)
30	4408060044	V4 CARD LONG CONNECTOR WITH DISPLAY	34	* 28421	ASTRAL SEL 100 ELECTRODE (9 PLATES)
31	4408060144	PH ECCO E5 CARD WITHOUT DISPLAY	34	* 28422	ASTRAL SEL 160 ELECTRODE (9 PLATES)



CODE **60238, 60239, 60240, 66678, 66679, 66680**

DESCRIPTION: **ELECTROLYSIS DUAL PURE 60, 100, 160**

## OBSERVATIONS

POS	CODE	OBSERVATIONS
20	4408060128	FOR: 60238, 66678
20	4408060129	FOR: 60239, 66679
20	4408060101	FOR: 60240, 66680
34	54054	FOR: 60238, 66678
34	28421	FOR: 60239, 66679
34	28422	FOR: 60240, 66680

CODICE **60238, 60239, 60240, 66678, 66679, 66680**

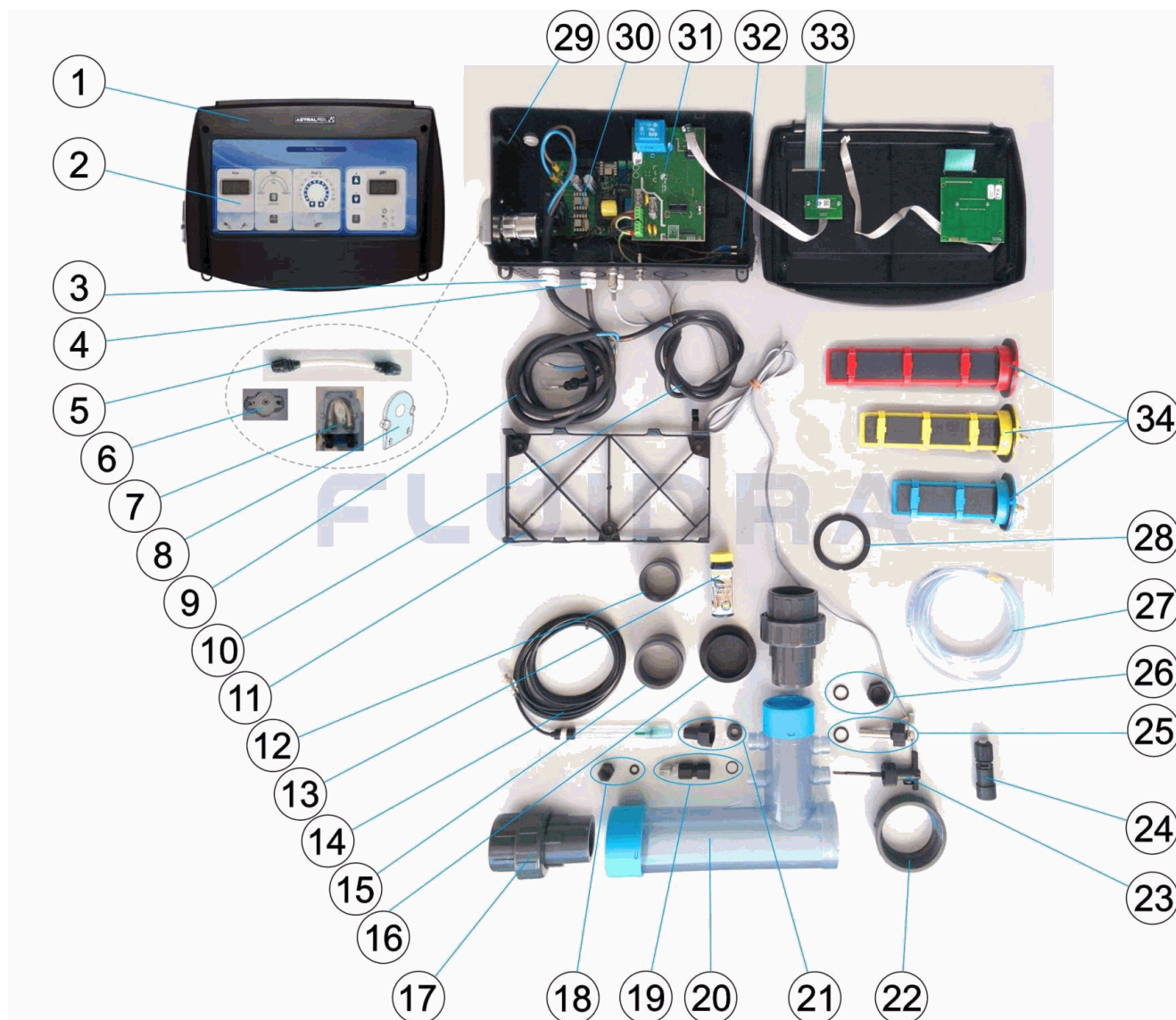
 DESCRIZIONE: **ELETTROLISI DUAL PURE 60, 100, 160**

**ITALIANO**

POS	CODICE	DESCRIZIONE	QUANTITA'	POS	CODICE	DESCRIZIONE	QUANTITA'
1	4408060043	COPERCHIO CORPO DUAL CORE		15	4408060102	RIDUZIONE 75/63	
2	4408060046	COPERCHIO DUAL PURE		16	4408060112	GRUPPO RACCORDO INIEZIONE PH	
3	4408060051	GRUPPO PREMISTOPPA PG11		17	4408060104	RACCORDO INCOLLAGGIO MF D.63	
4	4408060050	GRUPPO PREMISTOPPA PG16		18	4408060008	TAPPO PICCOLO INIEZIONE PER VASCA	
5	4408060022	TUBO IN LATEX		19	4408060019	PRESA DI INIEZIONE COMPLETA PER VAS	
6	4408040049	PORTA RULLI PH MODELLO 2 1,8-2,4		20	* 4408060128	PORTAELETTODI (60 M3)	
7	4408060039	POMPA PERISTALTICA 2.4 L/H		20	* 4408060129	PORTAELETTODI (100 M3)	
8	4408060080	COPERTURA TRANSPARENTA POMPA L3 M		20	* 4408060101	PORTAELETTODI (40 - 160 M3)	
9	4408060002	CAVO ELETTRODO		21	4408060116	PORTASONDA PH COMPLETO	
10	4408060003	CAVO DI ALIMENTAZIONE 3X1MM2 2.1M		22	4408060105	GHIERA D.92 ELETTRODO + GUARNIZIONI	
11	4408040037	SUPPORTO MURALE		23	4408060108	FLUSOSTATO COMPLETO	
12	4408060103	RIDUZIONE 63/50		24	4408060118	PRESA ASPIRAZIONE PH COMPLETA	
13	4408060007	ASTUCCIO ANALISI SEL		25	4408060026	PRESA A TERRA	

\* SI FACCIA RIFERIMENTO AL FOGLIO DELLE OSSERVAZIONI

CODICE **60238, 60239, 60240, 66678, 66679, 66680**

DESCRIZIONE: **ELETTROLISI DUAL PURE 60, 100, 160**

14	4408060117	SONDA PH	26	4408060121	TAPPO NERO PICCOLO + GUARNIZIONE
27	4408040028	TUBO PVC TRASPARENTE 4X6MM L=4M	32	4408060055	INTERRUTTORE
28	4408060106	GUARNIZIONE ELETTRODO	33	4408060057	SCHEDA PH ECCO E5
29	4408060028	SCATOLA IN SEL PURE V4	34	* 54054	ELETTRODO ASTRAL SEL 60 - 9 PLACHE
30	4408060044	SCHEDA V4 CONESSIONE LUNGA CON DISF	34	* 28421	ELETTRODO ASTRAL SEL 100 - 9 PLACHE
31	4408060144	SCHEDA PH ECCO E5 SENZA DISPLAY	34	* 28422	ELETTRODO ASTRAL SEL 160 - 9 PLACHE

**CODICE**                    **60238, 60239, 60240, 66678, 66679, 66680**

**DESCRIZIONE: Elettrolisi Dual Pure 60, 100, 160**

## OSSERVAZIONI

POS	CODICE	OSSERVAZIONI
20	4408060128	PER: 60238, 66678
20	4408060129	PER: 60239, 66679
20	4408060101	PER: 60240, 66680
34	54054	PER: 60238, 66678
34	28421	PER: 60239, 66679
34	28422	PER: 60240, 66680

CODE **60238, 60239, 60240, 66678, 66679, 66680**

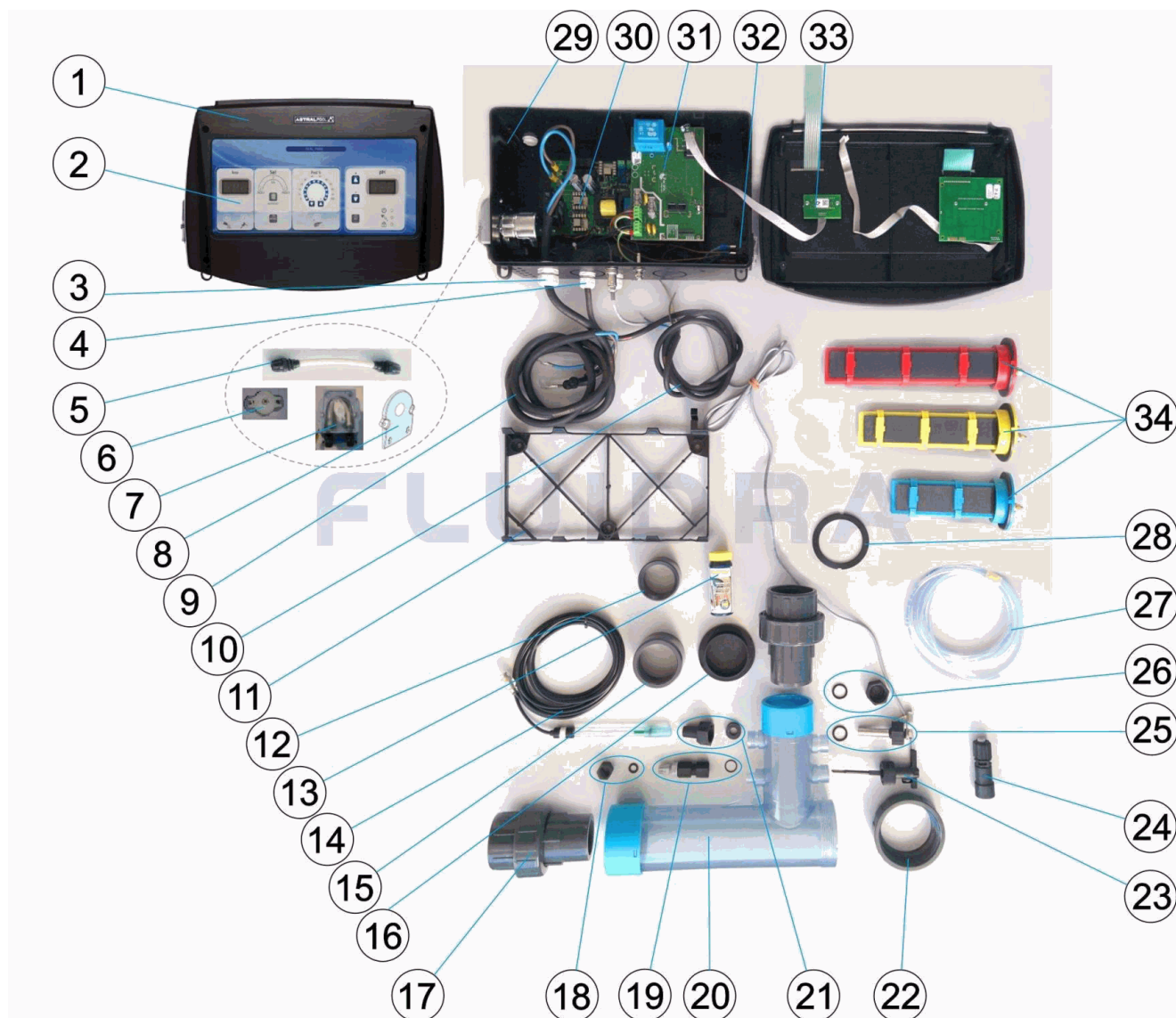
 BESCHREIBUNG: **ELEKTROLYSE DUAL PURE 60, 100, 160**

**DEUTSCH**

POS	CODE	BESCHREIBUNG	MENGE	POS	CODE	BESCHREIBUNG	MENGE
1	4408060043	ABDECKUNG GEHÄUSE DUAL PURE		15	4408060102	REDUZIERSTÜCK 75/63	
2	4408060046	BEDIENFELD DUAL PURE		16	4408060112	SET GEWINDESTÜCK	
3	4408060051	SET QUETSCHVERSCHRAUBUNG PG11		17	4408060104	GEWINDESTÜCK VERBINDUNG - KRAGEN	
4	4408060050	SET QUETSCHVERSCHRAUBUNG PG16		18	4408060008	STOPFEN KLEIN FÜR GEHÄUSE	
5	4408060022	LATEXROHR MIT GEWINDEN		19	4408060019	INJEKTIONSTEIL KOMPLETT FÜR GEHÄUSE	
6	4408040049	ROLLENSITZ PH MODELL 2 1,8 - 2,4		20	* 4408060128	ZELLENGEHÄUSE (60 M3)	
7	4408060039	PUMPE PH 2,4 L/H		20	* 4408060129	ZELLENGEHÄUSE (100 M3)	
8	4408060080	ABDECKUNG TRANSPARENT PUMPE L3 MO		20	* 4408060101	ZELLENGEHÄUSE (40 - 160 M3)	
9	4408060002	ELEKTRODENKABEL KOMPLETT		21	4408060116	SONDENHALTERUNG KOMPLETT FÜR GE	
10	4408060003	VERSORGUNGSKABEL 3X1MM2 2.1M		22	4408060105	MUTTER D. 92 ELEKTRODE SEL UND DICHT	
11	4408040037	WANDHALTERUNG		23	4408060108	DURCHFLUSSMESSER KOMPLETT	
12	4408060103	REDUZIERSTÜCK 63/50		24	4408060118	SAUGANSCHLUSS KOMPLETT	
13	4408060007	ANALYSEETUI SEL		25	4408060026	ERDUNG GEHÄUSE	

\* SIEHE ANMERKUNGSBLATT

CODE **60238, 60239, 60240, 66678, 66679, 66680**

BESCHREIBUNG: **ELEKTROLYSE DUAL PURE 60, 100, 160**

14	4408060117	PH-SONDE	26	4408060121	STOPFEN SCHWARZ VERSCHLUSS UND I
27	4408040028	ROHR PVC TRANSPARENT 4X6MM L=4M	32	4408060055	SCHALTER MIT HAUBE
28	4408060106	FLACHDICHTUNG ELEKTRODE SEL	33	4408060057	PLATINE PH ECCO E5 BILDSCHIRM SPOR
29	4408060028	GEHÄUSE SEL PURE V4	34	* 54054	SALZELECTRODE 60 - 9 PLATTEN
30	4408060044	PLATINE V4 ANSCHLUSS LANG MIT DISPLAY	34	* 28421	SALZELECTRODE 100 - 9 PLATTEN
31	4408060144	PLATINE PH ECCO E5 OHNE DISPLAY	34	* 28422	SALZELECTRODE 160 - 9 PLATTEN

CODE **60238, 60239, 60240, 66678, 66679, 66680**

BESCHREIBUNG: **ELEKTROLYSE DUAL PURE 60, 100, 160**

## HINWEISE

POS	CODE	HINWEISE
20	4408060128	FÜR: 60238, 66678
20	4408060129	FÜR: 60239, 66679
20	4408060101	FÜR: 60240, 66680
34	54054	FÜR: 60238, 66678
34	28421	FÜR: 60239, 66679
34	28422	FÜR: 60240, 66680

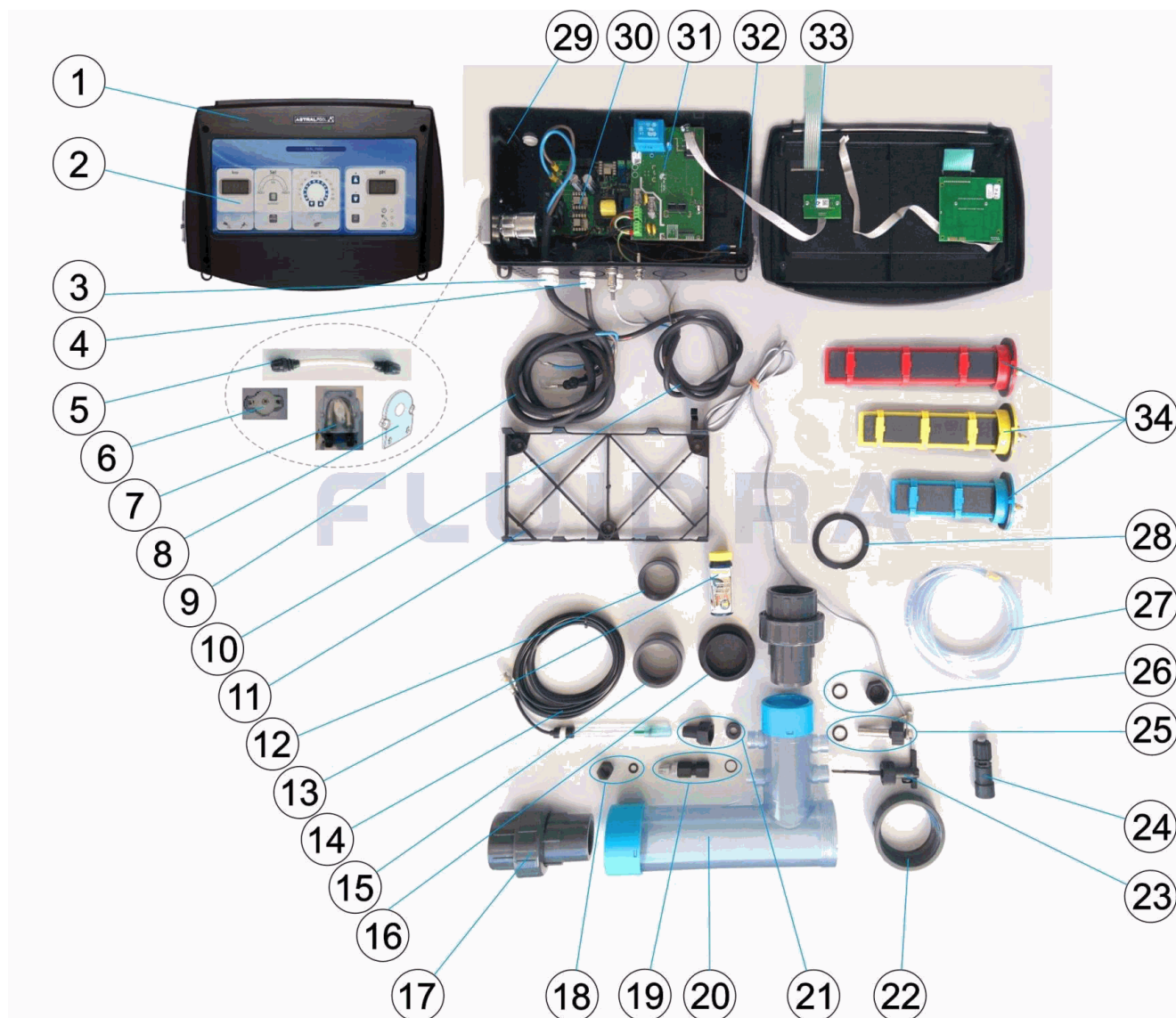

CODIGO **60238, 60239, 60240, 66678, 66679, 66680**

 DESCRIÇÃO: **ELECTRÓLISE DUAL PURE 60, 100, 160**

**PORTUGUES**

POS	CODIGO	DESCRIÇÃO	QUANTIDADE	POS	CODIGO	DESCRIÇÃO	QUANTIDADE
1	4408060043	TAMPA CORPO DUAL PURE		15	4408060102	REDUÇÃO 75/63	
2	4408060046	COBERTA DUAL PURE		16	4408060112	CONJUNTO RACORD	
3	4408060051	CJTO. PRENSA-ESTOPAS PG11		17	4408060104	RACORD DE UNIÃO A COLAR M/F. 63	
4	4408060050	CJTO. PRENSA-ESTOPAS PG16		18	4408060008	TAMPA PEQUENA INJEÇÃO PARA COPO	
5	4408060022	TUBO DE LÁTEX		19	4408060019	TOMADA INJEÇÃO COMPLETA PARA VA:	
6	4408040049	PORTA CILINDROS PH MODELO 2 1,8-2,4		20	* 4408060128	CARÇAÇA PORTA-CÉLULAS (60 M3)	
7	4408060039	BOMBA PERISTÁLTICA 2.4 L/H		20	* 4408060129	CARÇAÇA PORTA-CÉLULAS (100 M3)	
8	4408060080	COBERTURA TRANSPARENTE BOMBA L3 M		20	* 4408060101	CARÇAÇA PORTA-CÉLULAS (40 - 160 M3)	
9	4408060002	CABO Sonda		21	4408060116	PORTA-SONDA COMPLETO	
10	4408060003	CABO ALIMENTAÇÃO 3X1MM2 2.1M		22	4408060105	PORCA D. 92 ELÉCTRODO SEL + JUNTA	
11	4408040037	SUPORTE PAREDE		23	4408060108	FLUXO-ESTATO COMPLETO	
12	4408060103	REDUÇÃO 63/50		24	4408060118	TOMADA DE ASPIRAÇÃO COMPLETA	
13	4408060007	ESTOJO ANÁLISE SEL		25	4408060026	LIGAÇÃO A TERRA	

\* VEJA A FICHA DE OBSERVAÇÕES

CODIGO **60238, 60239, 60240, 66678, 66679, 66680**

DESCRIÇÃO: **ELECTRÓLISE DUAL PURE 60, 100, 160**

14	4408060117	SONDA PH	26	4408060121	TAMPÃO PRETO OBTURADOR + JUNTA
27	4408040028	TUBO PVC TRANSPARENTE 4X6MM L=4M	32	4408060055	INTERRUPTOR
28	4408060106	JUNTA PLANA ELÉCTRODO SEL	33	4408060057	PLACA PH ECCO E5
29	4408060028	CARÇA SEL PURE V4	34	* 54054	ELÉCTRODO SEL 60 - 9 PLACAS
30	4408060044	PLACA V4 FICHA COMPRIDA COM DISPLAY	34	* 28421	ELÉCTRODO SEL 100 - 9 PLACAS
31	4408060144	PLACA PH ECCO E5 SEM DISPLAY	34	* 28422	ELÉCTRODO SEL 160 - 9 PLACAS

CODIGO **60238, 60239, 60240, 66678, 66679, 66680**

DESCRIÇÃO: **ELECTRÓLISE DUAL PURE 60, 100, 160**

## OBSERVACÕES

POS	CODIGO	OBSERVACÕES
20	4408060128	PARA: 60238, 66678
20	4408060129	PARA: 60239, 66679
20	4408060101	PARA: 60240, 66680
34	54054	PARA: 60238, 66678
34	28421	PARA: 60239, 66679
34	28422	PARA: 60240, 66680