

CODIGO **01364**

DESCRIPCION: **MANGO FIJO 2,5 MTS. PALOMILLAS**

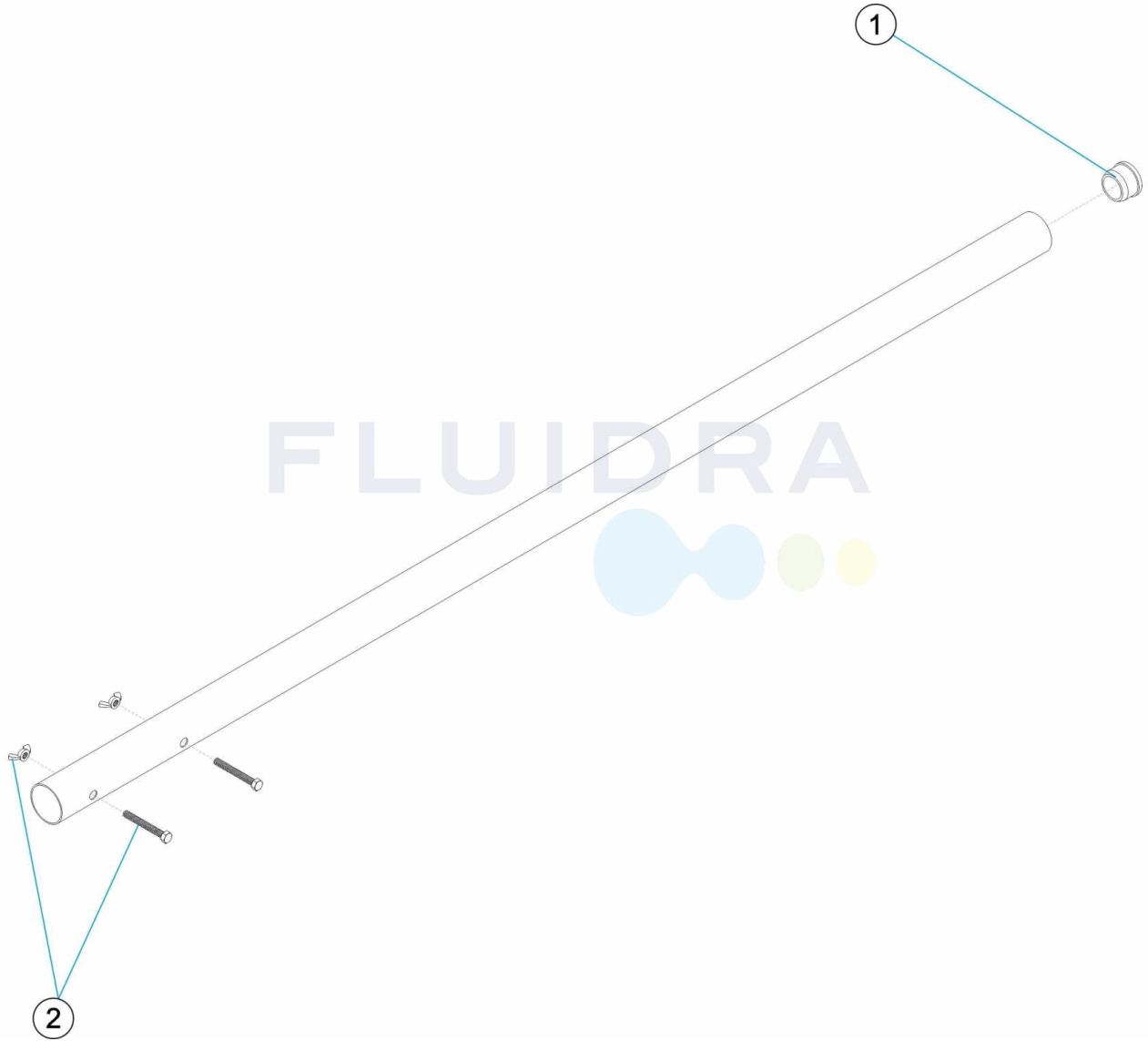

ESPAÑOL

| POS | CODIGO | DESCRIPCION | POS | CODIGO | DESCRIPCION |
|-----|------------|-------------|-----|------------|------------------------------|
| 1 | 4406030101 | TAPON MANGO | 2 | 4406030102 | PALOMILLAS Y TORNILLOS MANGO |

CODE **01364**

DESCRIPTION: **MANCHE FIXE 2,5 M ÉCROUS PAPILLON**

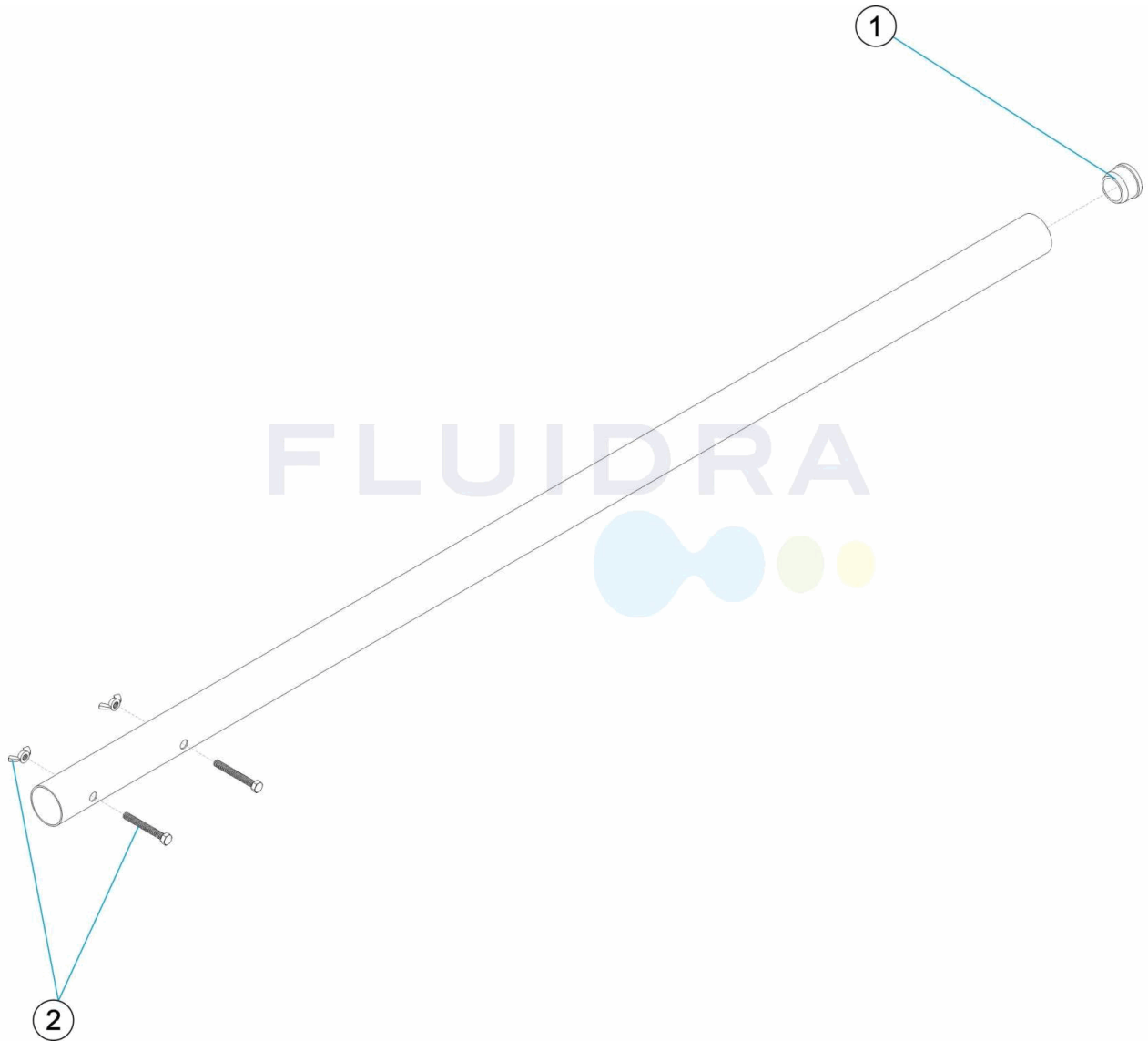

FRANCAIS

| POS | CODE | DESCRIPTION | POS | CODE | DESCRIPTION |
|-----|------------|-------------------|-----|------------|-------------------------|
| 1 | 4406030101 | BOUCHON DE MANCHE | 2 | 4406030102 | PAPILLONS ET VIS MANCHE |

CODE **01364**

DESCRIPTION: **FIXED HANDRAIL 2.5 METRES WALL BRACKETS**

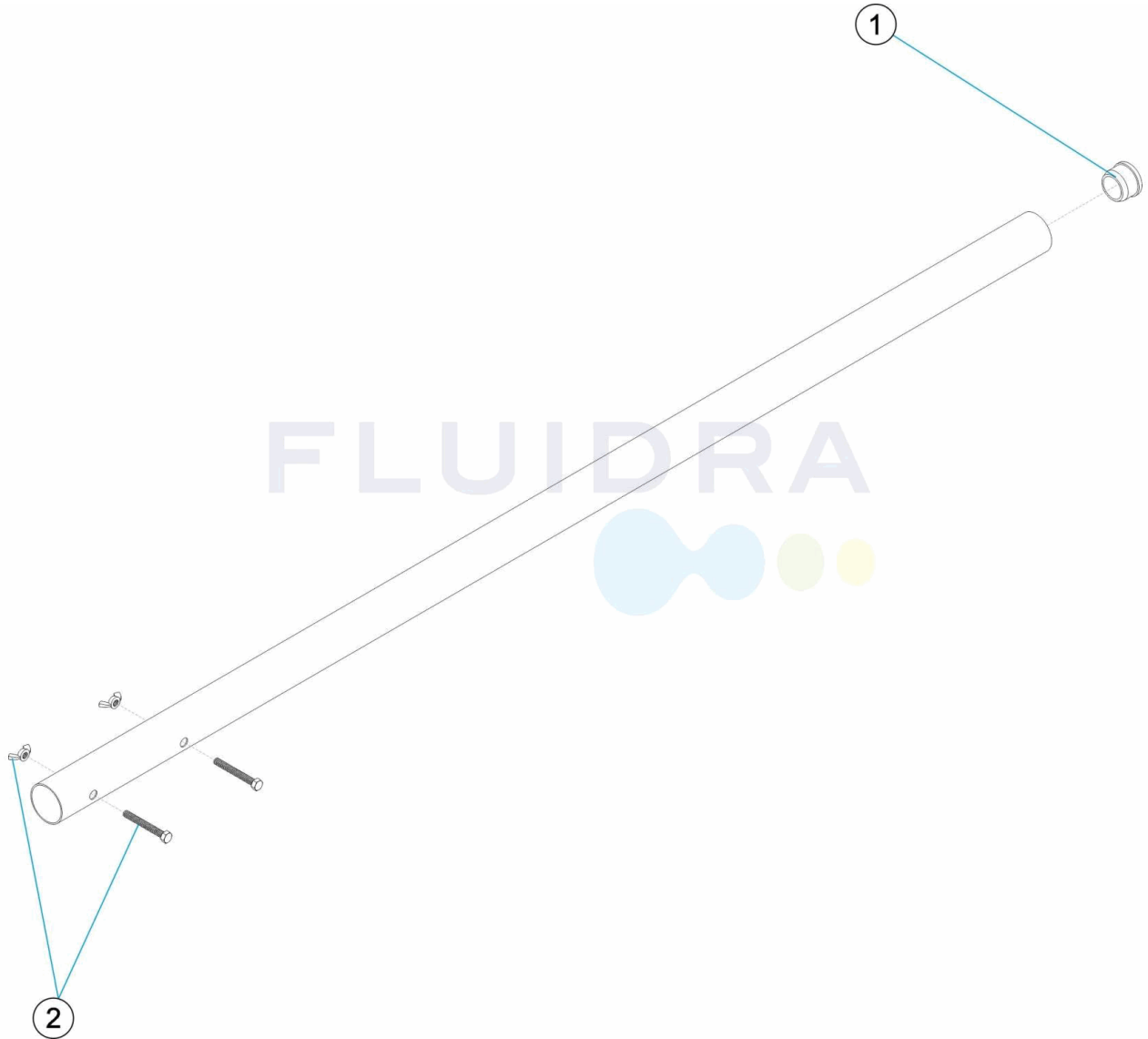

ENGLISH

| POS | CODE | DESCRIPTION | POS | CODE | DESCRIPTION |
|-----|------------|-------------|-----|------------|------------------------------|
| 1 | 4406030101 | HANDLE PLUG | 2 | 4406030102 | HANDLE BUTTERFLY NUT & BOLTS |

CODICE **01364**

DESCRIZIONE: **MANICO FISSO 2,5 METRI GALLETTI**

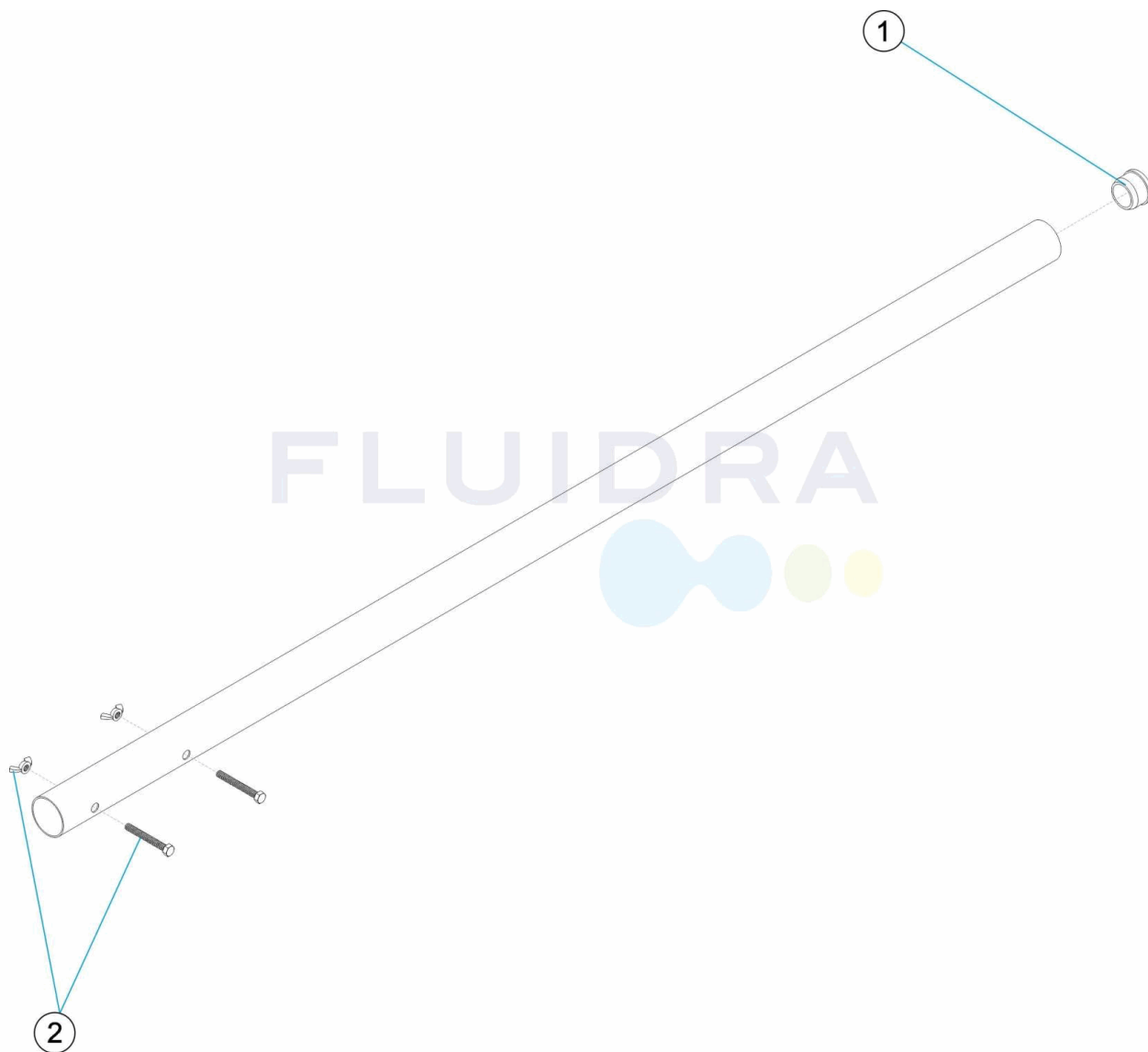

ITALIANO

| POS | CODICE | DESCRIZIONE | POS | CODICE | DESCRIZIONE |
|-----|------------|------------------|-----|------------|----------------------------|
| 1 | 4406030101 | COPERCHIO MANICO | 2 | 4406030102 | FARFALLE E VITI PER MANICO |

CODE **01364**

BESCHREIBUNG: **GRIFF FIX 2,5 M FLÜGELMUTTERN**

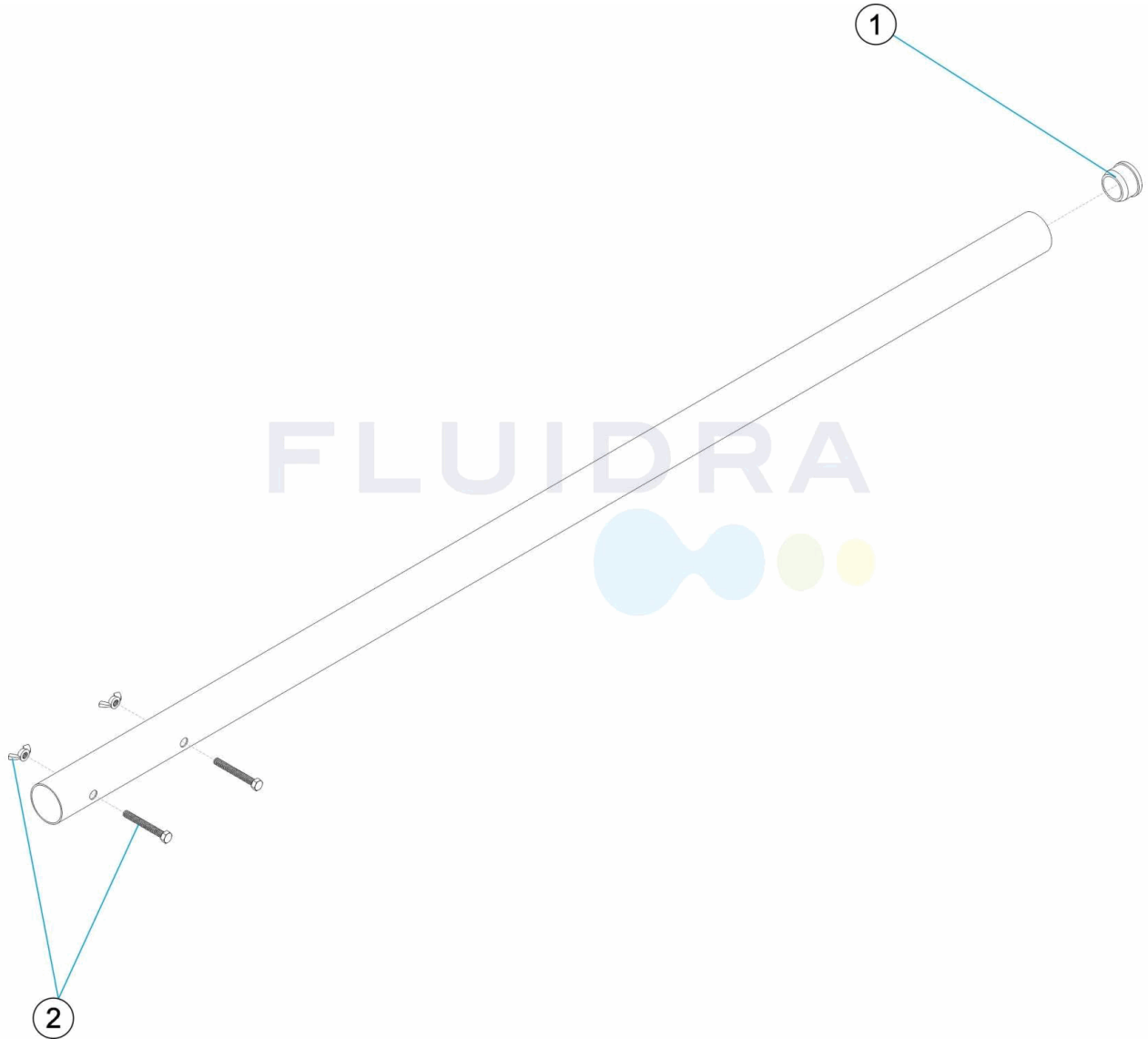

DEUTSCH

| POS | CODE | BESCHREIBUNG | POS | CODE | BESCHREIBUNG |
|-----|------------|---------------|-----|------------|-----------------------------------|
| 1 | 4406030101 | STOPFEN GRIFF | 2 | 4406030102 | FLÜGELMUTTERN UND SCHRAUBEN GRIFF |

CODIGO 01364

DESCRIÇÃO: CABO FIXO 2,5 M PLACAS SUPORTE

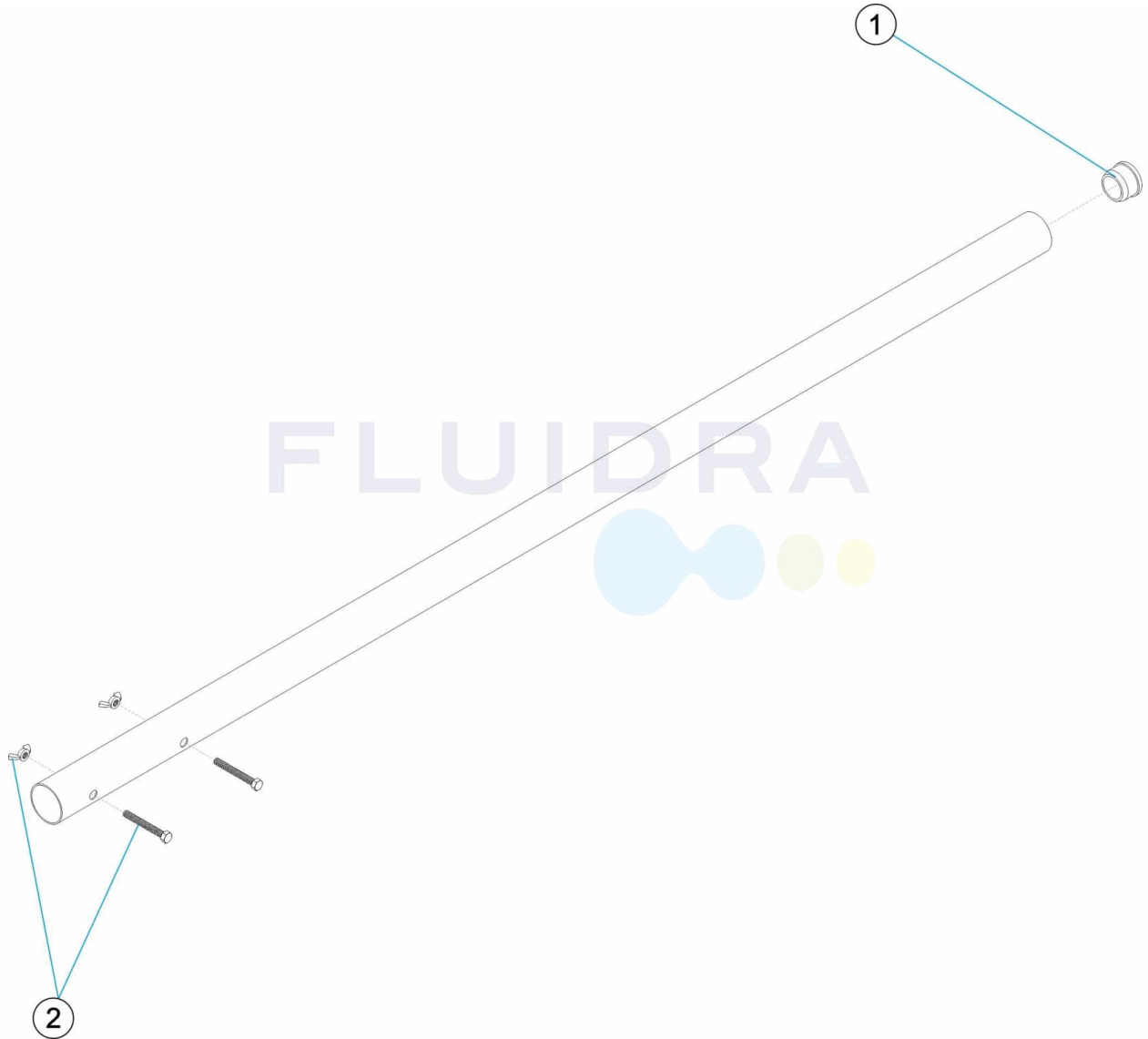

PORTUGUES

| POS | CODIGO | DESCRIÇÃO | POS | CODIGO | DESCRIÇÃO |
|-----|------------|-------------------------------------|-----|------------|-------------------------|
| 1 | 4406030101 | TAMPÃO CABO 2,5 MTS. LIG. PARAFUSOS | 2 | 4406030102 | PORCAS E PARAFUSOS CABO |