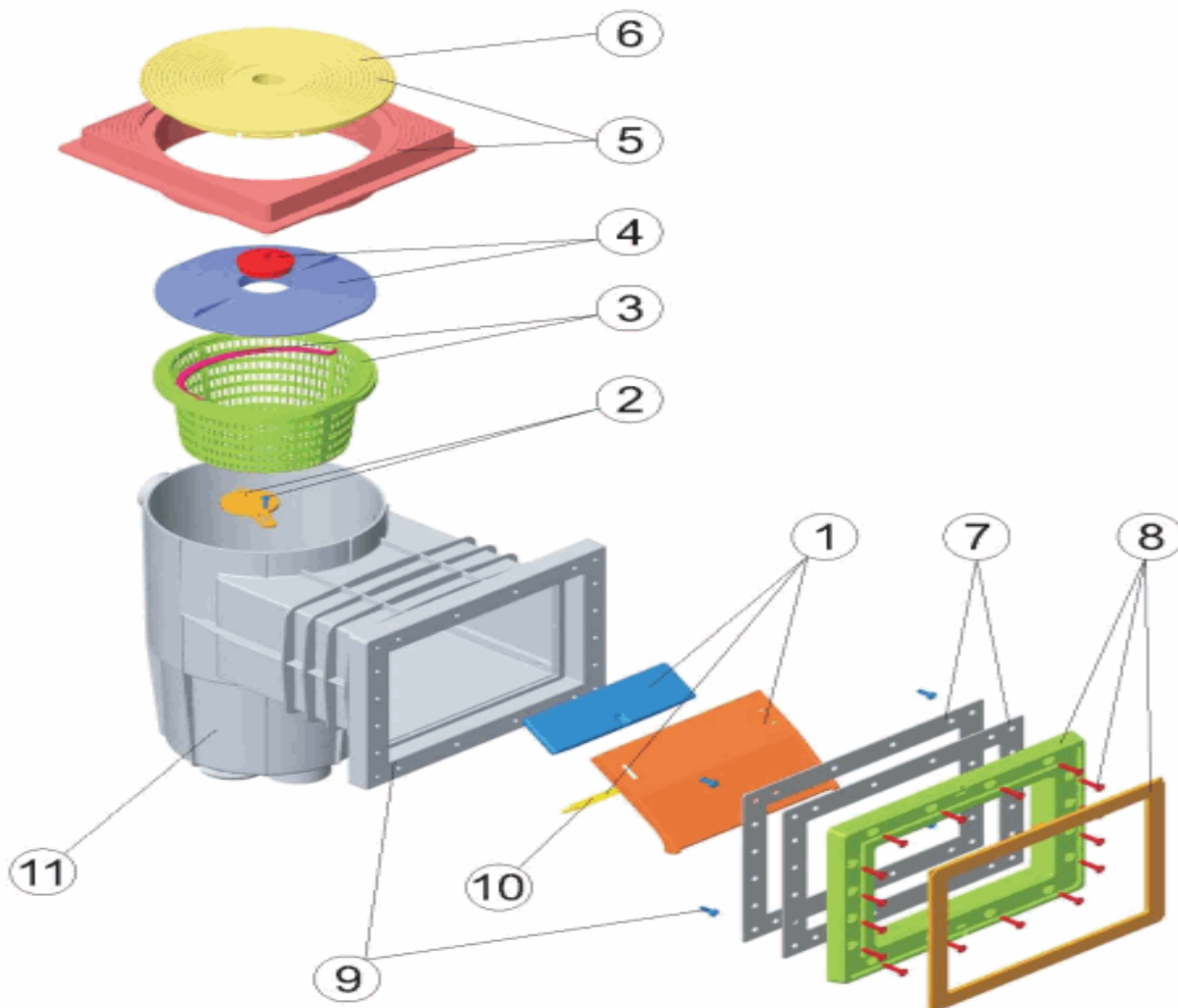
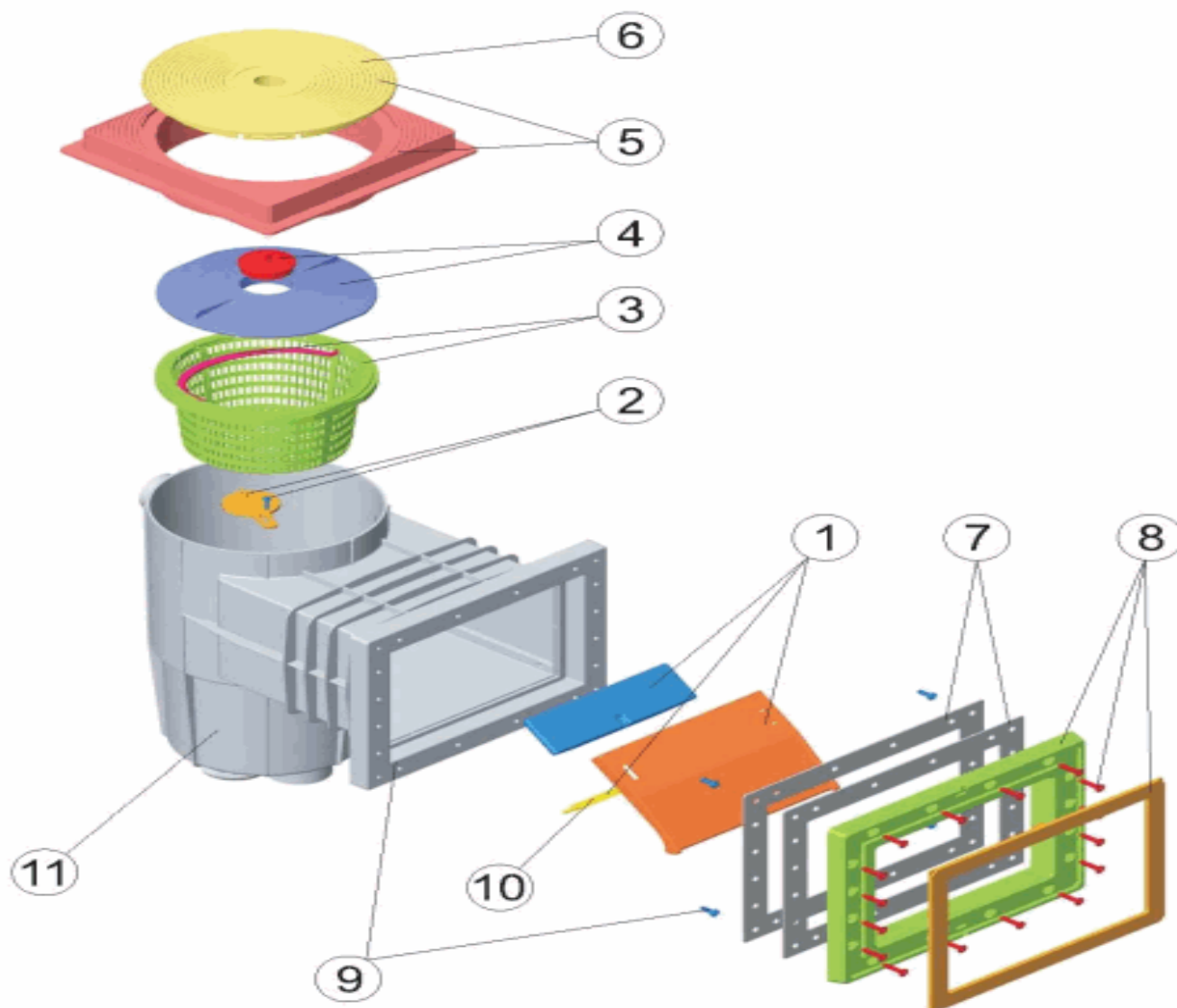

CODE **06472**

 BESCHREIBUNG: **SKIMMER 15L MÜNDUNG STANDARD DECKEL QUADRATISCH SELBSTPRÄGEND**

DEUTCHE

POS	CODE	BESCHREIBUNG	POS	CODE	BESCHREIBUNG
1	4402010101	SKIMMERKLAPPE	7	4402010307	DICHTUNG FÜR SKIMMER KLEIN FOLIE
2	4402010102	ABDECKKAPPE	8	4402010312	FLANSCHSATZ (PARKER)
3	4402010103	SKIMMERKORB	9	4402010314	RAHMEN FÜR VERLÄNGERUNG (PARKER)
4	4402010104	SAUGANSCHLUSSPLATTE + STOPFEN	10	4402010110	ACHSE SKIMMERKLAPPE
5	4402010106	SKIMMERDECKELSATZ QUADRATISCH	11	00249R0011	SKIMMERKÖRPER
6	4402010108	SKIMMERDECKEL RUND			

CODE **06472**

 DESCRIPTION: **SQUARE SKIMMER 15L B.ST**

ENGLISH

POS	CODE	DESCRIPTION	POS	CODE	DESCRIPTION
1	4402010101	FLAP RETAINING CLIP	7	4402010307	SMALL SKIMMER GASKETS FOR LINER POOL
2	4402010102	KEYHOLE FLAP	8	4402010312	SMALL SKIMMER FRAME (PARKER)
3	4402010103	SKIMMER BASKET	9	4402010314	ADAPTOR FRAME (PARKER)
4	4402010104	VACUUM PLATE WITH PLUG	10	4402010110	HINGE FLAP
5	4402010106	SQUARE LID AND LID FRAME	11	00249R0011	SKIMMER BODY
6	4402010108	CIRCULAR SKIMMER LID			

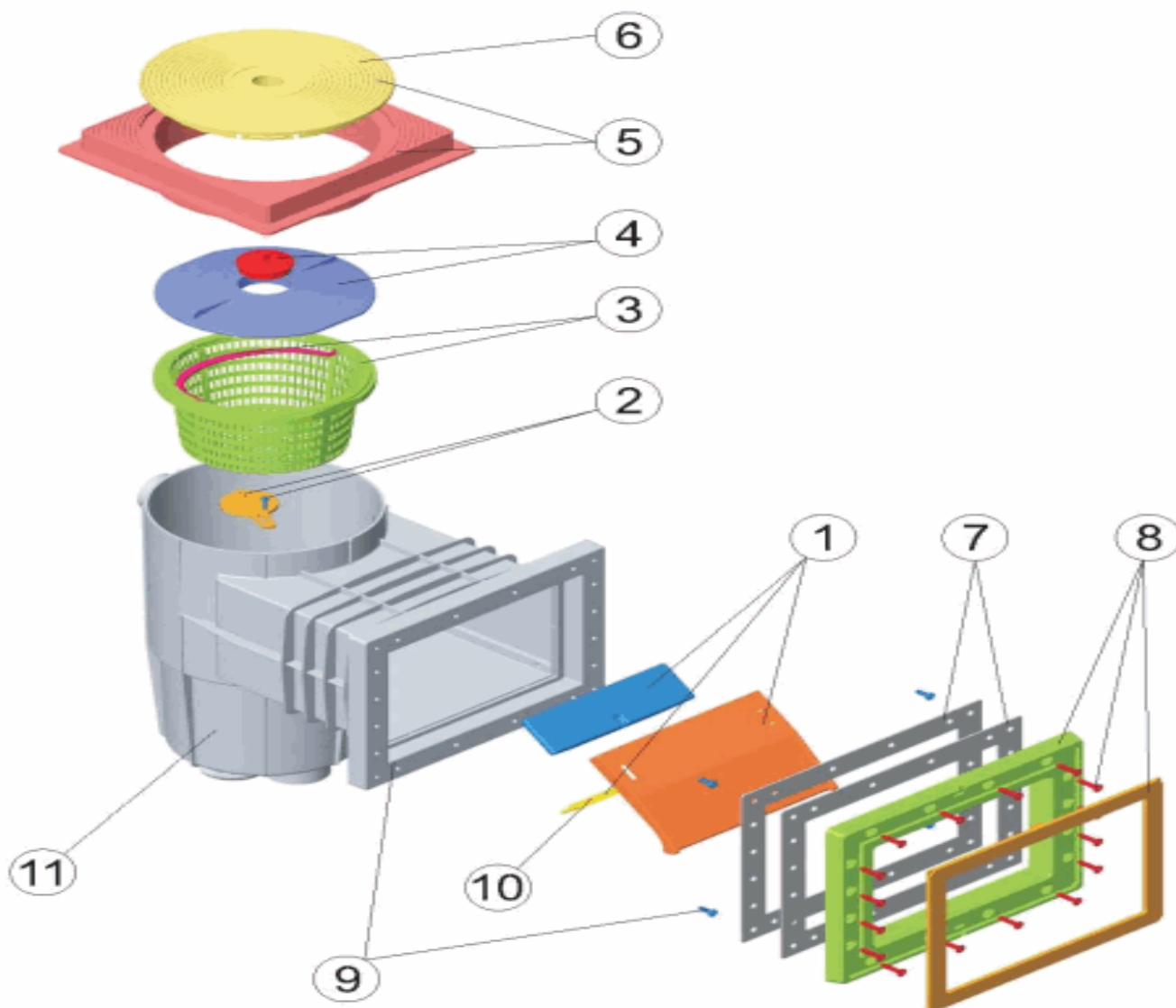
CODIGO **06472**

 DESCRIPCION: **SKIMMER 15L B.ST. T.CUADRADA AUTOR.**

ESPAÑOL

POS	CODIGO	DESCRIPCION	POS	CODIGO	DESCRIPCION
1	4402010101	COMPUERTA SKIMMER BISAGRA	7	4402010307	JUNTA SKIMMER PEQUEÑA PISC. PREF.
2	4402010102	CLAPETA SKIMMER	8	4402010312	MARCO PEQUEÑO SKIMMER (PARKER)
3	4402010103	CESTO SKIMMER	9	4402010314	MARCO ADAPTADOR BOCA (PARKER)
4	4402010104	TAPA CESTO SKIMMER CON TAPON	10	4402010110	BISAGRA COMPUERTA
5	4402010106	TAPA Y ARO CUADRADO SKIMMER	11	00249R0011	CUERPO SKIMMER 15L 2004
6	4402010108	TAPA CIRCULAR SKIMMER			

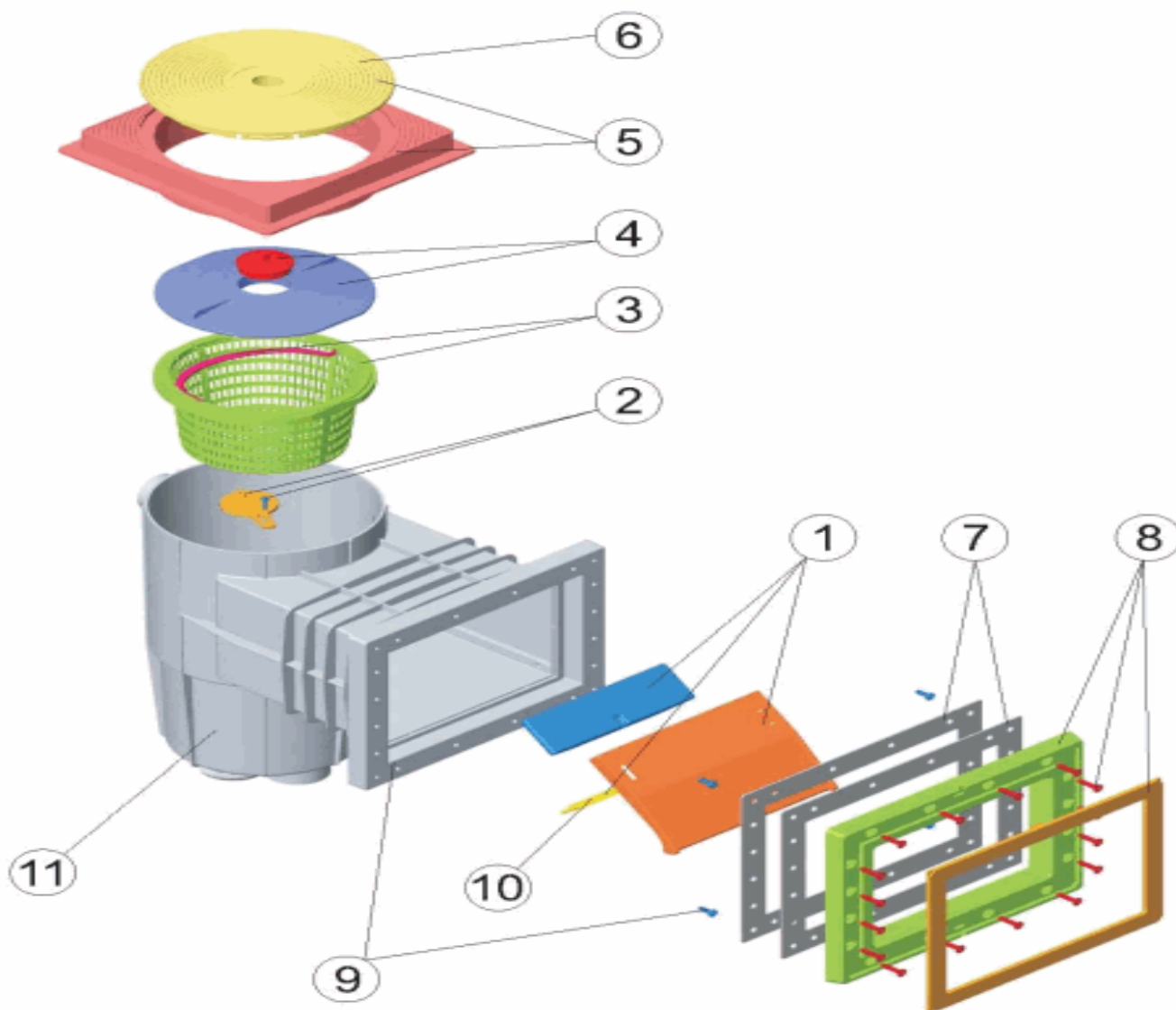
CODE **06472**

 DESCRIPTION: **SKIMMER 15L B.ST. C.CARRÉ AUTOT.**

FRANCAIS

POS	CODE	DESCRIPTION	POS	CODE	DESCRIPTION
1	4402010101	VOLET ET CHARNIERE SKIMMER	7	4402010307	JOINT SKIM PETIT MODELE PISCINE LINER
2	4402010102	CLAPET SKIMMER	8	4402010312	PETIT CADRE SKIMMER (PARKER)
3	4402010103	PANIER SKIMMER	9	4402010314	CADRE ADAPTATEUR BOUCHE (PARKER)
4	4402010104	COUVERCLE PANIER SKIMMER AVEC BOUCHON	10	4402010110	CHARNIERE VOLET
5	4402010106	COUVERCLE ET CADRE CARRE SKIMMER	11	00249R0011	CORPS DU SKIMMER 15L
6	4402010108	COUVERCLE ROND SKIMMER			

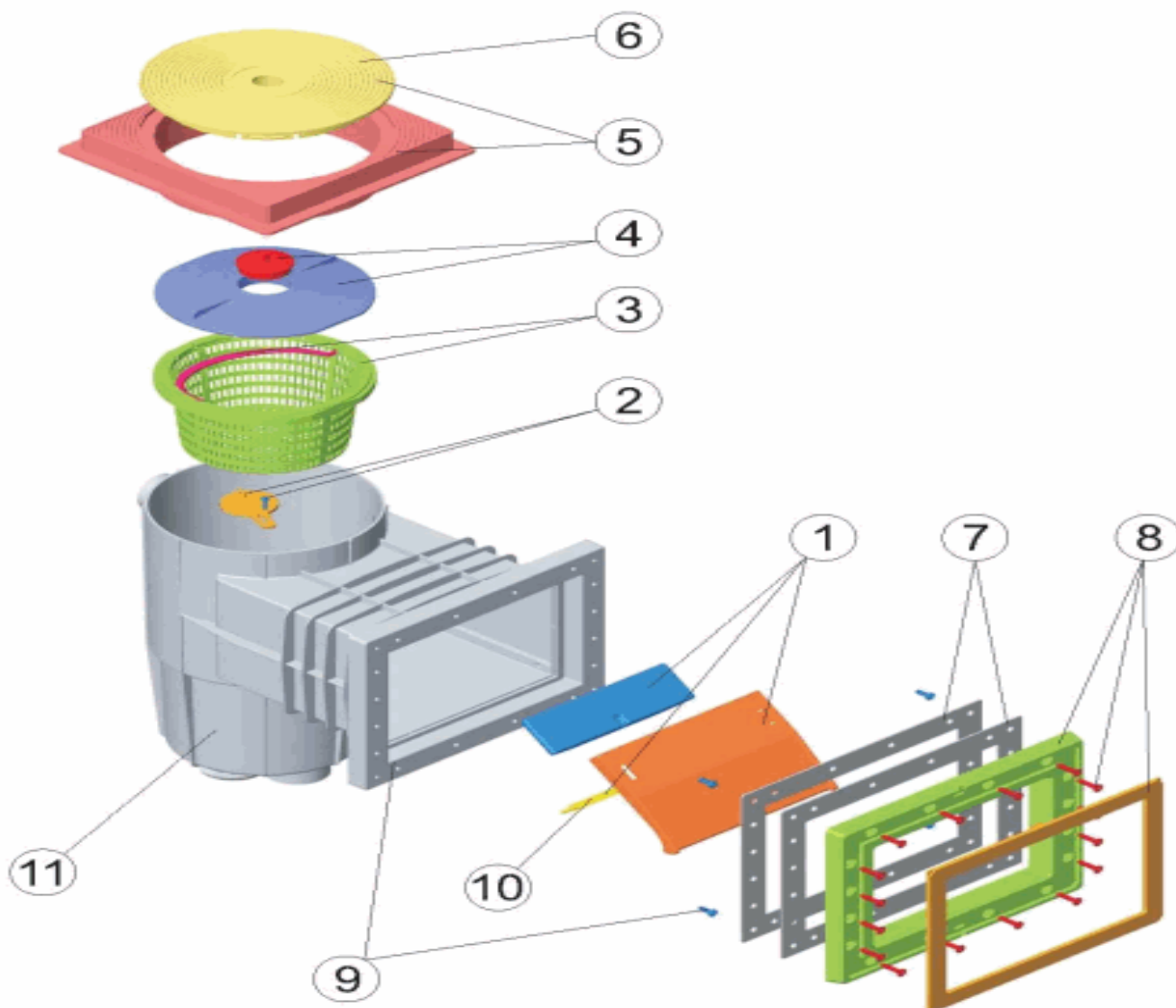
CODICE **06472**

 DESCRIZIONE: **SKIMMER 15L B. STD. TAPPO QUADRATO AUTOFILETTANTE**

ITALIANO

POS	CODICE	DESCRIZIONE	POS	CODICE	DESCRIZIONE
1	4402010101	BATTENTE SKIMMER CON PERNO	7	4402010307	GUARNIZIONE PER SKIMMER BASE P.F.
2	4402010102	ALETTA PARZIALIZZATRICE SKIMMER	8	4402010312	FLANGIA SKIMMER (PARKER)
3	4402010103	CESTELLO SKIMMER	9	4402010314	FLANGIA ADATTATORE BOCA (PARKER)
4	4402010104	COPERCHIO CESTELLO SKIMMER CON TAPPO	10	4402010110	CERNIERE BATTENTE
5	4402010106	COPERCHIO E CORNICE QUADRA SKIMMER	11	00249R0011	CORPO SKIMMER 15 L
6	4402010108	COPERCHIO TONDO SKIMMER			

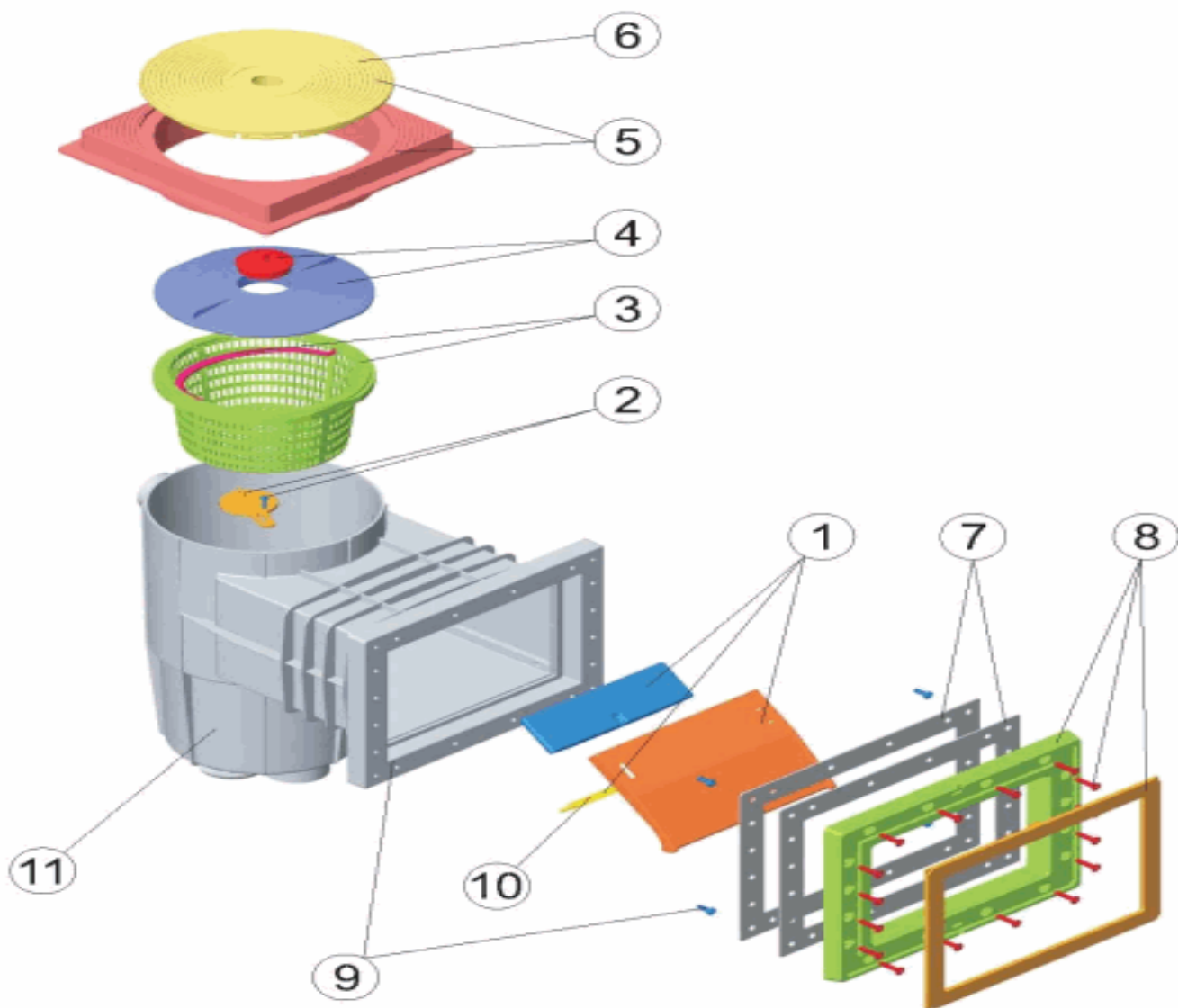
<p>CODIGO</p> <p>DESCRÇÃO:</p>	<p>06472</p> <p>SKIMMER 15 L B. ST. T. QUADRADA AUTOR.</p>
--------------------------------	--



PORTUGUES

POS	CODIGO	DESCRIÇÃO	POS	CODIGO	DESCRIÇÃO
1	4402010101	COMPORTA SKIMMER BISAGRA	7	4402010307	JUNTA PEQUENA DE SKIMMER
2	4402010102	CLAPETA SKIMMER	8	4402010312	CAIXILHO BOCA SKIMMER (PARKER)
3	4402010103	CESTO SKIMMER	9	4402010314	CAIXILHO ADAPTADOR BOCA (PARKER)
4	4402010104	TAMPA CESTO SKIMMER	10	4402010110	DOBRADIÇA COMPORTA
5	4402010106	TAMPA E ARO QUADRADO SKIMMER	11	00249R0011	SKIMMER 15L 2004
6	4402010108	TAMPA CIRCULAR SKIMMER			