

## CARACTERÍSTICAS TÉCNICAS TECHNICAL CHARACTERISTICS



▼ El Switch System es un surtidor dinámico ideal para fuentes interactivas tipo Funsquare, para producir juegos de agua rápidos con el control individual de cada uno de los surtidores instalados.

El diseño de este surtidor permite realizar cambios de estado sin golpes de ariete en la instalación.

Para fuentes secas existe la opción del Switch System con nicho de acero inoxidable 316 y proyectores led RGB-DMX integrados.

Switch System is a dynamic jet ideal for interactive fountains such as Funsquare type, to produce fast water games with individual control for each installed jet. The design of this jet allows state changes without water hammer in the installation.

For dry fountains there is the option of the Switch System with 316 stainless steel niche and integrated led RGB-DMX projectors.



### SWITCH NICHE

<b>Código / Code:</b>	<b>66572</b>
Dimensiones (L x W x H) [mm]	494 x 494 x 500
Dimensions (L x W x H) [mm]	
Material	Stainless steel 316
Material	
Peso[kg]	19
Weight [kg]	

### SWITCH SYSTEM

<b>Código / Code:</b>	<b>66570</b> (Niche not included)	
Dimensiones (LxWxH) [mm]	Dimensions (LxWxH) [mm]	210 x 120 x 261
Tensión nominal [V]	Nominal Voltage [V]	24 VDC
Potencia [W]	Power [W]	25
Intensidad nominal [A]	Nomial Current [A]	1,2
Conexiones hidráulicas	Water connections	1-1/2" G
Caudal máximo [l/min]	Maximum flow [l/min]	290
Presión máxima [bar]	Maximum pressure [bar]	3,2
Pérdida de carga Qn [bar]	Pressure drop Qn [bar]	0,4
Material	Material	Stainless steel 316 / Brass
Peso[kg]	Weight [kg]	6
Grado protección	Protection class	IP 68
Requisitos hidráulicos	Hydraulic requirements	130 microns filtered water

DIMENSIONES  
DIMENSIONS

Código / Code:

**66570** (Niche not included)

**66572** (Switch not included)

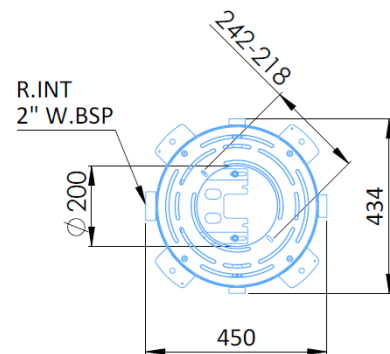
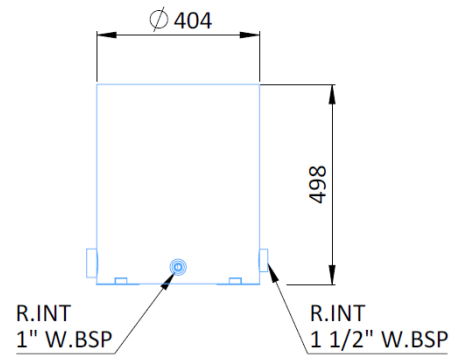
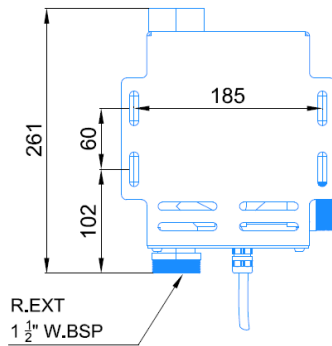
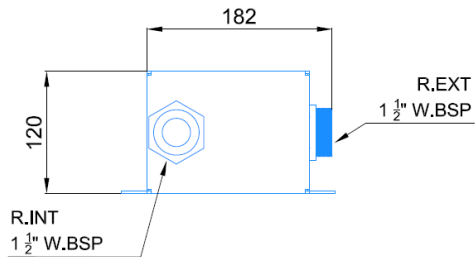

EJEMPLOS  
EXAMPLES

